

ROCKVILLE

HOME MATRIX

4 ZONE 8-CHANNEL 600W RMS MULTIRoom/
MULTISOURCE RECEIVER/AMPLIFIER

OWNER'S MANUAL

ATTENTION:
WATCH THIS VIDEO BEFORE FIRST USE!

Who reads manuals?

Scan the **QR code** or go to rockvillesupport.com/home-matrix-4 to access how-to video(s), the owner's manual, and other important information you may need to get the most out of your item.

If you prefer written instructions, please read ahead!

With Rockville you get many options.



Missing items? If you ordered a bundle that includes more than one product and you are missing part of your bundle then it just means your order shipped from two different warehouses. You will receive the remaining items very soon. If you have any concerns or inquiries, feel free to call our customer support center at 1-646-758-0144, 24hours a day/7 days a week.

Thank you for purchasing this Rockville product. Please read this installation guide carefully for proper use of your HOME MATRIX 4 Multiroom/Multisource Amplifier/Receiver. Should you need assistance, please call our technical help line at 1-646-758-0144, 24 hours a day/7 days a week.

Includes

- Matrix Amplifier
- Remote
- Detachable Rack mount ears
- Power Cable
- Owner's manual
- Warranty

IMPORTANT SAFETY INSTRUCTIONS



TO REDUCE THE RISK OF ELECTRICAL SHOCK, NEVER OPEN THE UNIT. THERE ARE NO USER-SERVICEABLE PARTS INSIDE. WE RECOMMEND SENDING THE UNIT TO THE ROCKVILLE SERVICE CENTER FOR ANY REPAIRS.

- Do not expose this unit to any kind of moisture.
- Please ensure that the unit is situated in a properly ventilated area.
- Do not attempt to operate this unit if the power cord has been frayed or broken.
- Do not attempt to break off or remove the ground prong. This prong is used to reduce the risk of electrical shock and fire in case of an internal short.
- Do not operate this unit if it is damaged.
- This unit is intended for indoor use only.
- Always mount this unit in a safe and stable manner.
- Power supply cords should be routed so that they are not likely to be walked on or pinched by items placed on or against them, paying particular attention to the point of exit from the unit.
- To avoid unnecessary wear and to improve the unit's life span, unplug the unit when not in use for extended periods of time.

Introduction

Multi Source/Multi Zone Matrix Routing

The Home Matrix 4 is a 4 zone home audio amplifier that allows you to route any source to any specific zone(s). For example, you can play Bluetooth on zones 1 and 2 and route microphone 1 to zones 1 and 2 while playing something in Zone 3 using an RCA input, and playing something else in zone 4 using the optical input.

Power and Flexibility

This is an 8 channel amplifier with 4 zones. Each zone has 2 sets of speaker outputs to power a left and right speaker. Each channel puts out 75 watts RMS @ less than 1 % THD. (Most ceiling speakers are around 40 watts only so this has more than enough head room). Each zone also has an RCA line output which allows you to add a subwoofer, or an additional amplifier, or more speakers to expand that zone.

Lots of Playback Options

This receiver has built in Bluetooth playback, USB playback, optical input, coaxial input, RCA input, FM radio, and 2 mic inputs.

Flexible Controls

The controls are really easy to use. You can easily route any source to any zone(s) and select the volume levels for that zone from the unit or from the included remote. There are bass and treble EQ controls to customize the sound. The mic inputs have mic volume, mic bass, mic treble, echo, and delay controls making this perfect for karaoke and PA announcements.

Applications

- Multi-room home audio
- Offices
- Restaurant
- Bar
- School

Functions

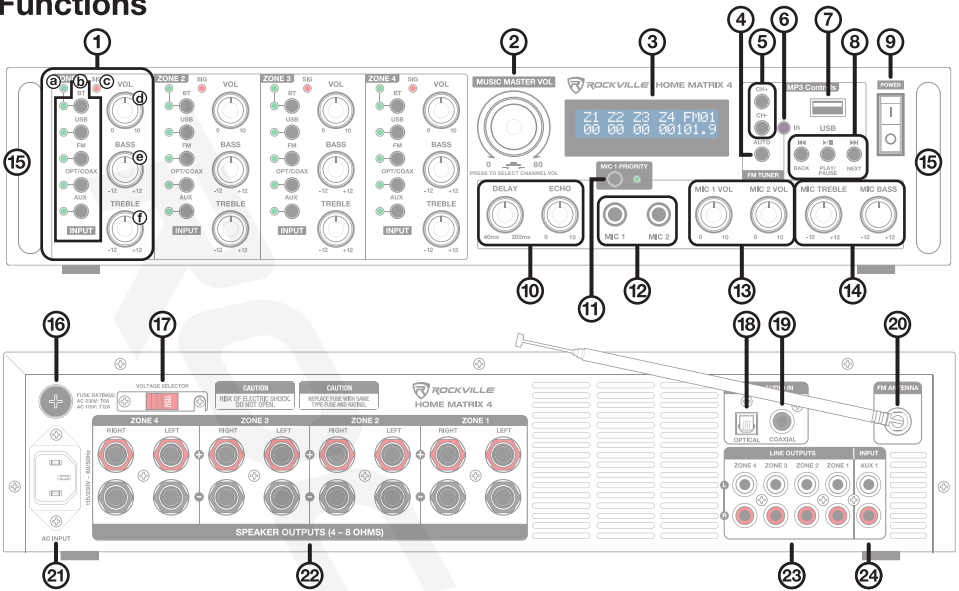

1. Individual zone controls
 - a. Bluetooth status LED (see page 7 for details)
 - b. Input selection buttons and indicator LEDs
 - c. Signal output indicator LED
 - d. Zone volume control knob
 - e. Zone bass control knob
 - f. Zone treble control knob
2. Music Master volume knob: Controls overall volume. Press to select and adjust volume for individual zones. Zones are shown on the display screen as Z1, Z2, Z3, and Z4. The selected zone's name will flash and the numerals underneath will change as per your adjustments. To exit individual zone volume adjustment mode, simply wait 2 to 3 seconds until the selected zone's name stops flashing.
3. LCD display
4. FM Radio auto scan button: Press to automatically scan and save all available stations. Press again to stop scan. Can save up to 40 stations.
5. CH-/CH+: Press to navigate forward or back through saved stations.
6. Remote control IR Sensor
7. USB input
8. MP3 module (USB mode only)
 - Play/Pause - Press to play or pause playback.
 - ⏮ (Previous) - Press this key to return to the previous track.
 - ⏭ (Next) - Press this key to proceed to the next track.
9. Power switch
10. Mic echo and delay controls (see page7)
11. Mic 1 Priority button (see page7)
12. 1/4" TS Mic inputs (see page7)
13. Independent mic volume controls (see page7)
14. 2 Band Mic EQ controls (see page7)
15. Rack handles

16. User-serviceable fuse compartment: AC230V - T6A/115V - T12A
17. Variable voltage selector switch
18. Optical input
19. Coaxial input
20. FM Antenna
21. AC power input
22. 5-Way Banana/Binding post speaker outputs
23. RCA Line outputs
24. RCA Line input

Remote Control

1. FM Radio Controls

CH-/CH+ - Press to navigate forward or back through saved stations.

FM Radio auto scan button - Press to automatically scan and save all available stations. Press again to stop scan. Can save up to 40 stations.

2. MP3 Controls

Play/Pause - Press to play or pause playback.

⏮ (Previous) - Press this key to return to the previous track.

⏭ (Next) - Press this key to proceed to the next track.

3. Mic 1 Priority button: for making announcements via Mic 1 input. When this function is active, the LED indicator will be solid green. Refer to page 7 for more details.

4. Master Volume: Controls overall music output volume. Press VOL- or VOL+ to decrease or increase the overall volume.

5. Mute. When you press the mute button a relay will go off and you will hear a click. This sound is normal and does not mean there is an issue with the unit.

6. Individual zone controls

Input - Press to select input source (BT, USB, FM Radio, Optical/Coax, and Aux).

VOL-/VOL+ - Press to increase the zone's volume.

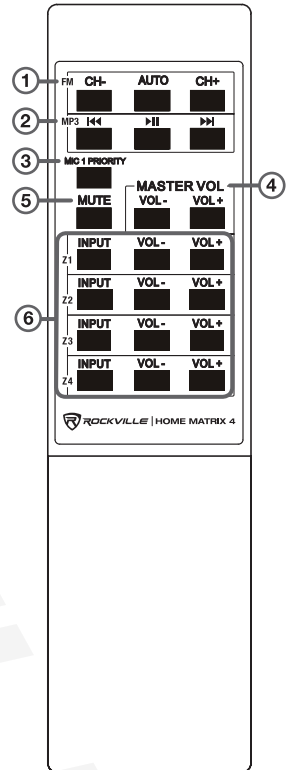

Inputs

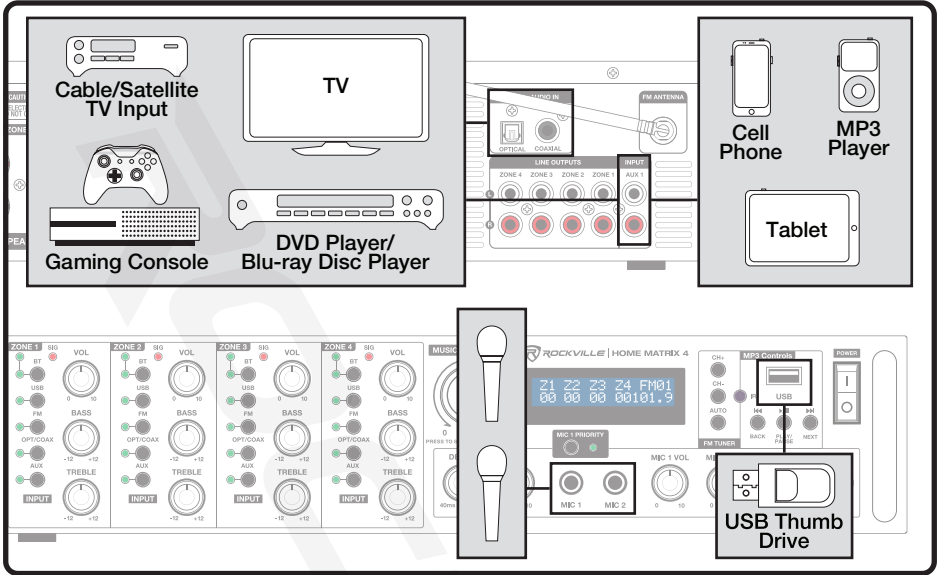

Outputs

Option 1

Connect one pair of 4-ohm or 8-ohm speakers to each zone.

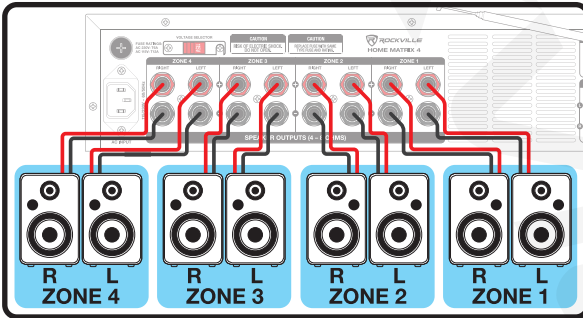

! ATTENTION: It's important that you match the impedance of your speakers to your amplifier. The HOME MATRIX 4 has a minimum speaker impedance of 4 ohms; hence, the total impedance of your speakers must not be less than 4 ohms.

Be sure to observe proper polarity.

Option 2

Two 8-ohm speakers, in parallel, attached to each zone.

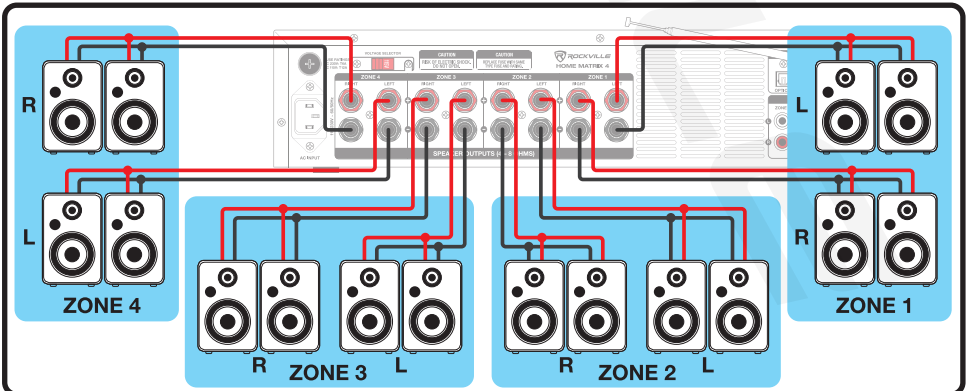

Bluetooth

Pairing

1. Turn the unit on and push the **BT** button on any of the zone control panels. The BT status LED will flash quickly indicating that the unit is in pairing mode.
2. Locate and select HOME MATRIX 4 on your BT devices list of available connections.
3. Upon successful pairing, the BT status LED will remain solid.
4. To unpair, disconnect via your BT device's BT control panel. The unit will remember the last paired device.

Playback

All playback functions are controlled via your BT device. Volume can be controlled via your device, the zone input's volume knob, and the master volume knob. Please note, all volumes work independently of each other.

USB

1. Plug a USB drive into the USB port on the front panel. The unit will automatically begin to play music stored on the external device.

Playback (controlled from the unit or the remote control)

1. **Play/Pause:** Press once to play current track; press again to pause.
2. **◀▶:** Press to return to previous track or proceed to the next track.

Please note, formatting the USB drive is not necessary, but if you do so, do not use the NTFS format. Supported file formats: MP3, WMA, WAV, FLAC, and APE.

Optical/Coaxial

Many TVs, digital set-top boxes, and receivers players have optical (fiber optic) and/or coaxial outputs.

Optical Input

1. Use a digital optical audio cable to connect the sound source to the amplifier.
2. Power on the sound source and the HOME MATRIX 4. Press the OPT/COAX button on the appropriate zone control panel or press that zone's input button the remote control.

Coaxial Input

1. Use a coaxial cable to connect the sound source to the amplifier.
2. Power on the sound source and the HOME MATRIX 4. Press the OPT/COAX button on the appropriate zone control panel or press that zone's input button the remote control.

Mic Connections, Mic Volume, Echo, Delay, and EQ

1. Connect wired mics (not included) to either one of the 1/4" mic jacks.
2. **Echo:** The echo effect adds a series of repeated, decaying echoes to a sound. Equalizing the delays will change a room's sound characteristics from one that has reflective surfaces (brighter-sounding echoes) to one that is totally absorptive (darker-sounding echoes).
3. **Delay:** Determines the amount of time between echo repetitions.
4. **Equalizer:** The bass and treble controls allow the user to make adjustments to these settings, which will affect overall microphone sound output.
5. **Mic 1 Priority:** for making announcements via the Mic 1 input. When this function is active, the LED indicator will be solid green and the volume of the music will lower when speaking through the mic. Please note, when the Mic 1 Priority button is pressed, input signal from this jack will override all other input signals.

Features

- 600 Watts Total RMS @ less than 1% THD (75 Watts RMS per zone x 8 zones)
- Route any sources to any zone
- Includes a remote with zone source and zone volume controls
- Supports 4 – 8 ohm speakers
- Bluetooth playback with quick phone connection and long range
- USB input to play audio stored on a thumb drive with matrix assigning to any zone
- RCA line input
- Optical input
- Coaxial input
- Built-in FM radio
- RCA output on each zone (four sets total)
- 8 sets of amplified speaker outputs
- Two ¼" Mic inputs will play on all zones
- Master volume control knob
- Source selection on each zone
- Bass, treble, and volume control on each zone
- Mic inputs have volume control, bass, treble, echo, and delay controls
- 19" rack mountable (removable rack brackets)
- MIC priority function
- Built-in variable speed fan cooling system keeps component cool at all times
- 110/220V switchable
- Frequency Response vs THD + N (Worst case, across normal bandwidth 1w @ 8ohm) : <1%
- Weight: 20.9Lbs
- Dimensions with the included rack mount ears attached: 19" x 3.5" x 10.4" inches
- Dimensions without rack mount ears: 16.9" x 3.5" x 10.4"

Troubleshooting

PROBLEM	SOLUTION
No power	<ol style="list-style-type: none">1. Make sure the unit is plugged in and the power switch is in the ON position.2. Check that the power cable is properly plugged into the wall socket.3. Check and replace the fuse if necessary.4. If people or equipment tend to step and roll over or stretch your power cable, it can get damaged. Check the power cable for damage. If the cable is damaged, discontinue using the unit until the cable can be repaired.
No sound/low sound/distorted sound	<ol style="list-style-type: none">1. Check that all appropriate cables and wires are plugged in correctly.2. Check the Master volume and Zone volume settings.3. Check the Microphone volume settings.4. Check the volume settings on your input devices.5. If using wall volume controls, be sure the volume is set properly.6. Make sure the proper input source is selected.7. Make sure you are using the proper type of speakers.8. Make sure speakers are wired correctly (plus to plus, minus to minus; not plus to minus or vice versa).9. Make sure speakers' power ratings match the amplifier's.
Buzzing sound	<ol style="list-style-type: none">1. Make sure you are using the proper cable. Check the requirements of the connected gear and the inputs on the amplifier and make sure you are using the appropriate cable. This unit's ¼" mic outputs are TS (balanced) so you will need a TS mic cable.2. For line inputs be sure to use high quality RCA cables.
Mic feedback or poor sound	<ol style="list-style-type: none">1. Point mics away from any nearby speakers.2. Make sure the microphones are on and the volume controls are properly set.3. Make sure the microphone cables are properly connected and that you are using good-quality TS mic-specific cables.
Bluetooth pairing fails	<ol style="list-style-type: none">1. Check to see that both devices are turned on and that your Bluetooth device is discoverable.2. Turn both devices off and then on again.3. Make sure you've selected the proper source.4. Make sure that the Bluetooth device is within 5 feet of the unit.5. Move both devices away from other Bluetooth devices.6. Make sure that the unit is not paired to a previously paired device.
No USB playback	<ol style="list-style-type: none">1. Make sure you've selected the proper source.2. Make sure that the audio files are in the specified format: MP3, WMA, WAV, FLAC, and APE3. Make sure the USB drive is not formatted in NTFS format.

FEDERAL COMMUNICATIONS COMMISSION COMPLIANCE INFORMATION

Responsible party name: Rockville

Address: 600 Bayview Ave.
Entrance A
Inwood, NY 11096

Hereby declares that the product(s) HOME MATRIX 4 complies with FCC rules as mentioned in the following paragraph:

This device complies with Part 15 of the FCC rules. Operation is subject to the following two conditions: (1) this device may not cause harmful interference, and (2) this device must accept any interference received, including interference that may cause undesired operation.

Note: This equipment has been tested and found to comply with the limits for a Class B digital device, pursuant to Part 15 of the FCC rules. These limits are designed to provide reasonable protection against harmful interference in a residential installation. This equipment generates, uses, and can radiate radio frequency energy and, if not installed and used in accordance with the instructions, may cause harmful interference to radio communications. However, there is no guarantee that interference will not occur in a particular installation. If this equipment does cause harmful interference to radio or television reception, which can be determined by turning the equipment off and on, the user is encouraged to try to correct the interference by one or more of the following measures:

- Reorient or relocate the receiving antenna.
- Increase the separation between the equipment and receiver.
- Connect the equipment to an outlet on a circuit different from that to which the receiver is connected.
- Consult the dealer or an experienced radio/TV technician for help.

ROCKWELL

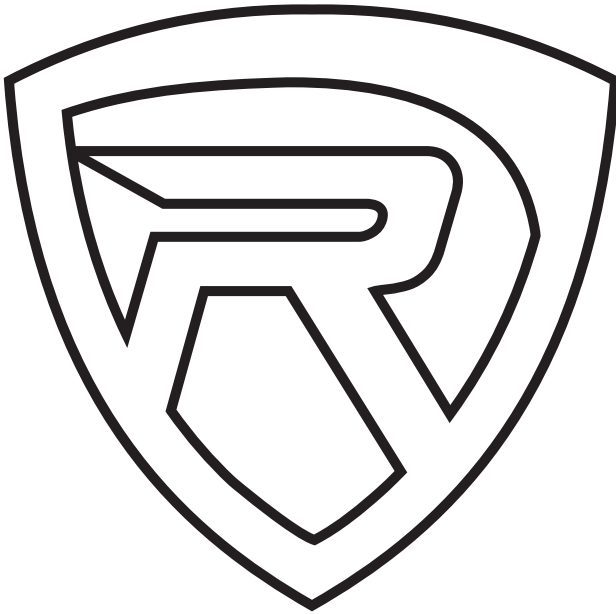

RockvilleAudio.com

© 2022 ROCKVILLE // Features and specifications are subject to change and/or improvement without notice.