

ROCKVILLE

POWER GIG Series

Powered Active 2-Way DJ PA Speaker Systems

OWNER'S MANUAL

**ATTENTION:
WATCH THIS VIDEO BEFORE FIRST USE!**

Scan the **QR codes** or visit the **URLs** for essential information, guides (video and/or written), and tips to make the most out of your purchase.

If you prefer written instructions, please read ahead!

With Rockville you get many options.

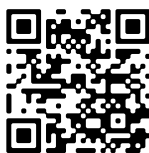

rockvillesupport.com/rpg8



rockvillesupport.com/rpg10



rockvillesupport.com/rpg12



rockvillesupport.com/rpg15

Missing items? If you ordered a bundle that includes more than one product and you are missing part of your bundle then it just means your order shipped from two different warehouses. You will receive the remaining items very soon. If you have any concerns or inquiries, feel free to call our customer support center at 1-646-758-0144, 24 hours a day/7 days a week.

Thank you for purchasing this Rockville Power Gig series pro audio speaker. Please read this installation guide carefully for proper use of your Power Gig speaker. Should you need technical assistance please call our technical help line at 1-646-758-0144, 24 hours a day/7 days a week.

IMPORTANT SAFETY INSTRUCTIONS

- To reduce risk of electric shock, never open the unit. There are no user serviceable parts; refer service to the Rockville service center.
- Do not expose this unit to any kind of moisture.
- Please ensure that the unit is situated in a properly ventilated area.
- Make sure the unit is placed on a level and stable surface.
- This unit can operate with either 115V or 230V.

Setting Up Your RPG Professional Sound System

Your RPG is set up to produce the full spectrum of sound from its woofer and tweeter horn combination. The lower frequencies seek out the floor of the room they are playing and travel along the floor and walls. The tweeter horn is more directional. Hence when setting up your system its more important to make sure that the tweeter horns are not blocked by any furniture and are located / aimed at ear level to the listening audience. Woofer aiming is not as critical as explained previously due to the nature of the woofer sounds able to travel through various paths even when blocked.

It is therefore recommended that when setting up your system you set up your speakers on speaker stands, such as the Rockville model RVSS-2 (not included) so that the tweeter sounds will radiate above the listening crowd. This will guarantee optimum sound dispersion and achieve clear vocal sound reproduction.

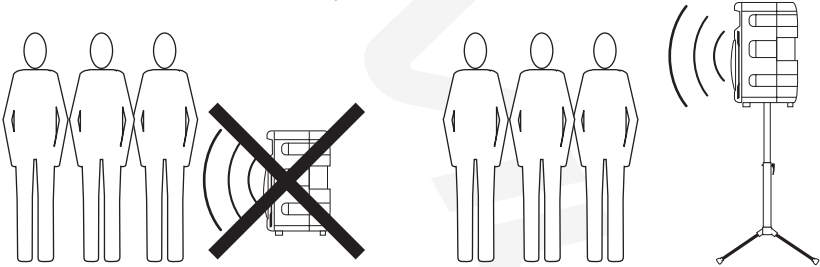

How To Avoid Irritating Feedback

The placement of your microphone is critical in avoiding feedback through your RPG system. Never set up your microphone in front of the speaker. Always set up your microphone behind the speaker. When approaching the speaker to make any adjustments, we recommend approaching the speaker from the rear and not walking directly towards the front of the speaker.



Stage Monitor Setup

The RPG15, RPG12, and RPG10 speakers come with two brackets which snap in to the cabinet sides allowing it to be placed on the floor at an angle as a stage monitor. Unlike a PA setup which face the crowd, stage monitors are set up to face the performer on stage and to direct the sound towards them. This presents a particular problem as now feed back may occur. To avoid stage monitor feedback the following precautions should be taken.

1. Choose a microphone with high directivity, i.e. cardioid or hyper-cardioid polar pattern.
2. Never point the microphone directly down in front of the speaker. Holding the microphone in normal position will allow you to be closer to the stage monitor with out feed back.
3. See illustration below as to position of microphones when mounted in stand. Cardioid polar patter microphones should always be at a 90 degree angle to the axis of the stage monitor. Hyper Cardioid polar pattern microphones should be positioned at an acute angle to the sage monitor.

You may choose to add a feedback eliminating processor to your system for additional flexibility on stage.

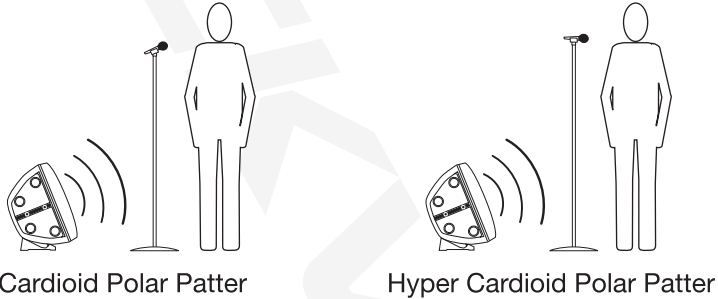

A Word About System Volume Controls and Gains.

There is really only one volume control on the RPG unit, that is the knob marked MASTER. The Mic In Balanced volume control and secondary input gain control are matching devices to match the preamp voltages of items such as microphones and guitars or other musical instruments with your RPG unit. Never turn these up to maximum unless indicated by the instructions below. With a properly matched signal your system will produce less distortion, be subject to less feedback, and will produce louder, cleaner and clearer sound. Use the Master control as your volume once all inputs are matched properly. Your RPG features a CLIP LED indicator to help you set and match your components. Please be sure to read all set up instructions so your RPG sounds its best.

SETTING LEVEL CONTROLS

It is best practice to set your input level controls (gains) in the manner shown below.

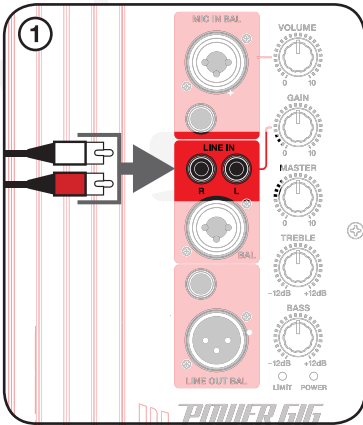

For this instance we will be using the Line In RCA jacks.



Set the volume of the external stereo signal source (mixer, keyboard, electronic drums, CD player, DVD music player, smart phone, MP3 player, etc.) to 60%. If using a device with RCA outputs, use an RCA to 1/4" TRS cable.

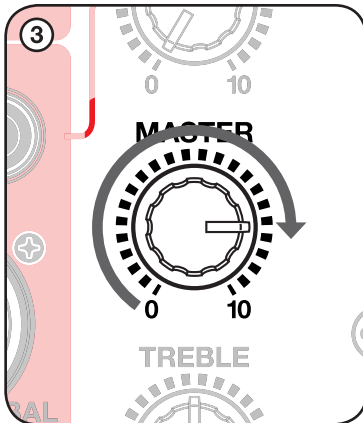

Set the Master volume to 75%.

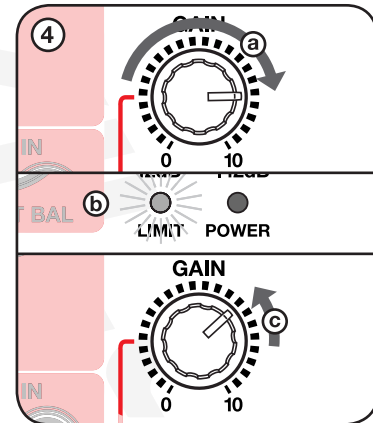

Slowly turn up the input's level, in this case the Gain controller (a). As soon as the clip indicator LED goes on (b) or you hear any distortion – turn it down one or two notches (c).

SETTING LEVEL CONTROLS (continued)

After you set the levels on all input devices, you can readjust the RPG's levels as necessary. When adjusting the Mic level controls, you must speak into the microphone and adjust the level control as needed. This is because adjustments to the mic input are a matter of mic volume in relation to the music volume and not necessarily a clipping issue.

! PLEASE NOTE

Because mixers feature two volume controls (channel level and master), when connecting one via the XLR line in port, the procedure is slightly different. The RPG's master volume should be set to 50% and the Gain level control should be set to 50%. Set the mixer master volume to 50% and make the adjustments in Step 4 on the mixer channel level control. If after making these adjustments the signal still isn't strong enough, you can additionally boost the signal by turning up the Gain level control.

APPLICATION USES

Microphone Presentations

Your RPG features ultra-low noise mic input via an XLR port or a 1/4" TRS jack.

1. Make sure the Power switch is in the OFF position.
2. Plug your microphone into either the XLR port or 1/4" jack. **Never use both at once.**
3. Switch on the RPG unit.
4. Refer to the "Setting Level Controls" section of this manual for instructions on how to properly adjust the input level controls (gains).

Always stand behind the speaker when making your microphone adjustments to avoid feedback distortion.

Line Input

These models feature ultra-low noise Line input via an XLR port or RCA jacks. Use the XLR input when you wish to hook up an additional stereo signal source: mixers, keyboards, electronic drums, CD players, DVD music players, etc. You can use the RCA jacks when you wish to hook up an additional stereo signal source (smart phones, CD players, DVD music players, MP3 players etc.) without the use of a mixer console.

1. Make sure the Power switch is in the OFF position.
2. Connect an external stereo signal source to the XLR input or the RCA jacks. **Never use both at once.**
3. Switch on the RPG unit.
4. Refer to the "Setting Level Controls" section of this manual for instructions on how to properly adjust the input level controls (gains).

Public Address/Concert Mixer

When setting up for larger venues, a mixing console becomes a critical piece of equipment for appropriately mixing signals from multiple inputs such as singers, speakers, effects devices, musicians and of course allows for multiple speaker utilization.

1. Make sure the Power switch is in the OFF position.
2. Turn Master volume to 0 position.
3. Turn Gain level to 0 position.
4. Connect the LEFT SPEAKER OUTPUT of mixer to the XLR Line In connection of your Left RPG unit. Connect the RIGHT SPEAKER OUTPUT of mixer to the XLR Line In connection of your Right RPG unit.

Public Address/Concert Mixer

5. Switch on the RPG unit.
6. Slowly raise the level of the mixer output to the 0dB level position.
7. Slowly turn up the input's level, in this case the Gain controller (a). As soon as the clip indicator LED goes on (b) or you hear any distortion – turn it down one or two notches (c).
8. Turn Master volume up to achieve proper volume.

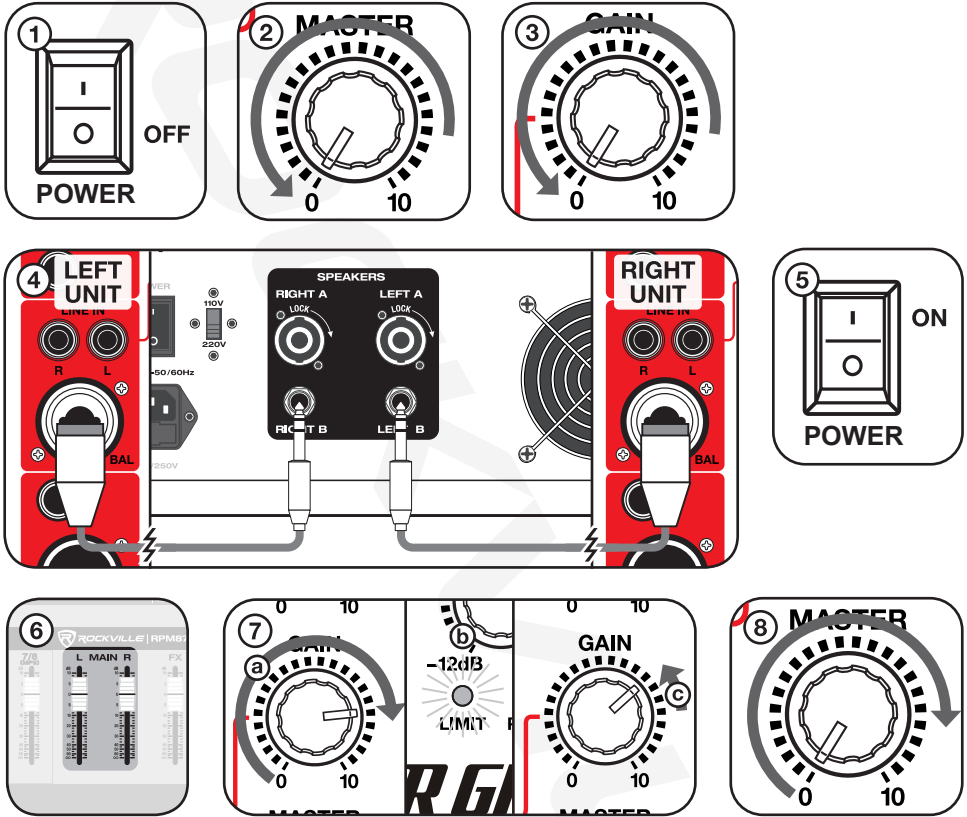

Line Out Balanced Connection.

The output marked Line Out allows for daisy chaining of signals from one RPG unit to another. Simply attach an XLR to XLR (RPG10, RPG12, and RPG15 only) or 1/4" TRS to XLR cable (RPG8, RPG12, and RPG15 only) between the two units to share signals. The input to second RPG should go to the Line In port. Additionally you can use the balanced line output to connect a subwoofer.

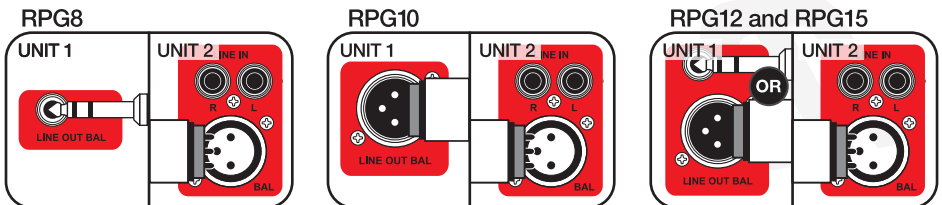

APPLICATION USES

Line Input Feature

You can use the Line Input function when you wish to hook up an additional stereo signal source without the use of a mixer console. Mixers, CD players, DVD music players, MP3 players, etc can be plugged directly into the XLR/RCA jacks labeled LINE IN.

1. Make sure the Power switch is in the OFF position.
2. Turn Master volume to 0 position.
3. Turn Gain level to 0 position.
4. Connect the music source to the XLR input or RCA jacks marked LINE IN.
5. Switch ON your RPG unit.
6. Connect the LEFT SPEAKER OUTPUT of mixer to the XLR Line In connection of your Left RPG unit. Connect the RIGHT SPEAKER OUTPUT of mixer to the XLR Line In connection of your Right RPG unit.
7. Turn Master Volume up to achieve proper volume.

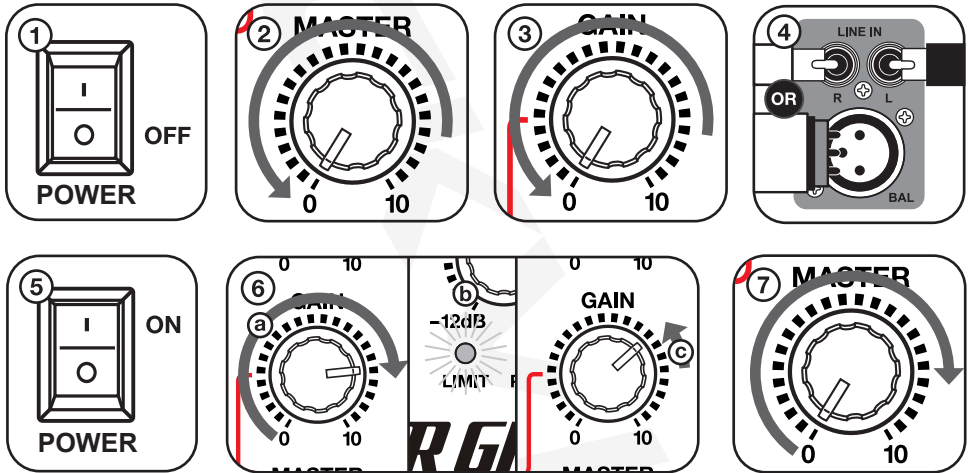

Balanced use with XLR connectors

The audio inputs and outputs of the RPG unit are fully balanced. To maximize interference compensation we recommend establishing balanced connections to other equipment whenever possible.

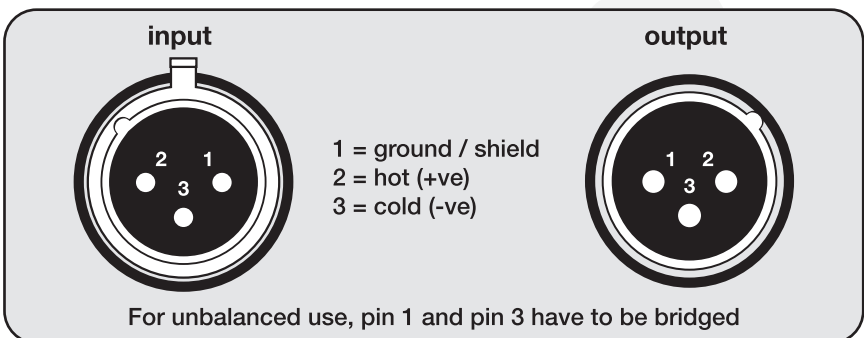

Front Side Peak Level Limiter

Your RPG unit features a blue LED on the cabinet front to the left of the woofer. This LED is not a clip indicator but a system level meter. You do not have to be concerned if this LED lights steadily or blinks, it is simply monitoring your musical output and indicating to you proper function of the RPG unit.

Functions (Although the RPG15's amp panel is pictured, the information applies to all RPG models unless otherwise noted.)

1. Balanced XLR and ¼" TRS jack microphone inputs
2. Microphone input volume control
3. RCA and XLR line input gain control
4. RCA and XLR line input
5. Master volume control
6. Treble control
7. Bass control
8. Amplifier clip limit LED indicator and Power LED indicator
9. Balanced XLR and ¼" TRS line output (RPG12 and RPG15 only)
 - a. RPG8 has ¼" TRS line output only
 - b. RPG10 has balanced XLR output only
10. Voltage selector switch
11. IEC AC power socket with user serviceable fuse
12. Power switch

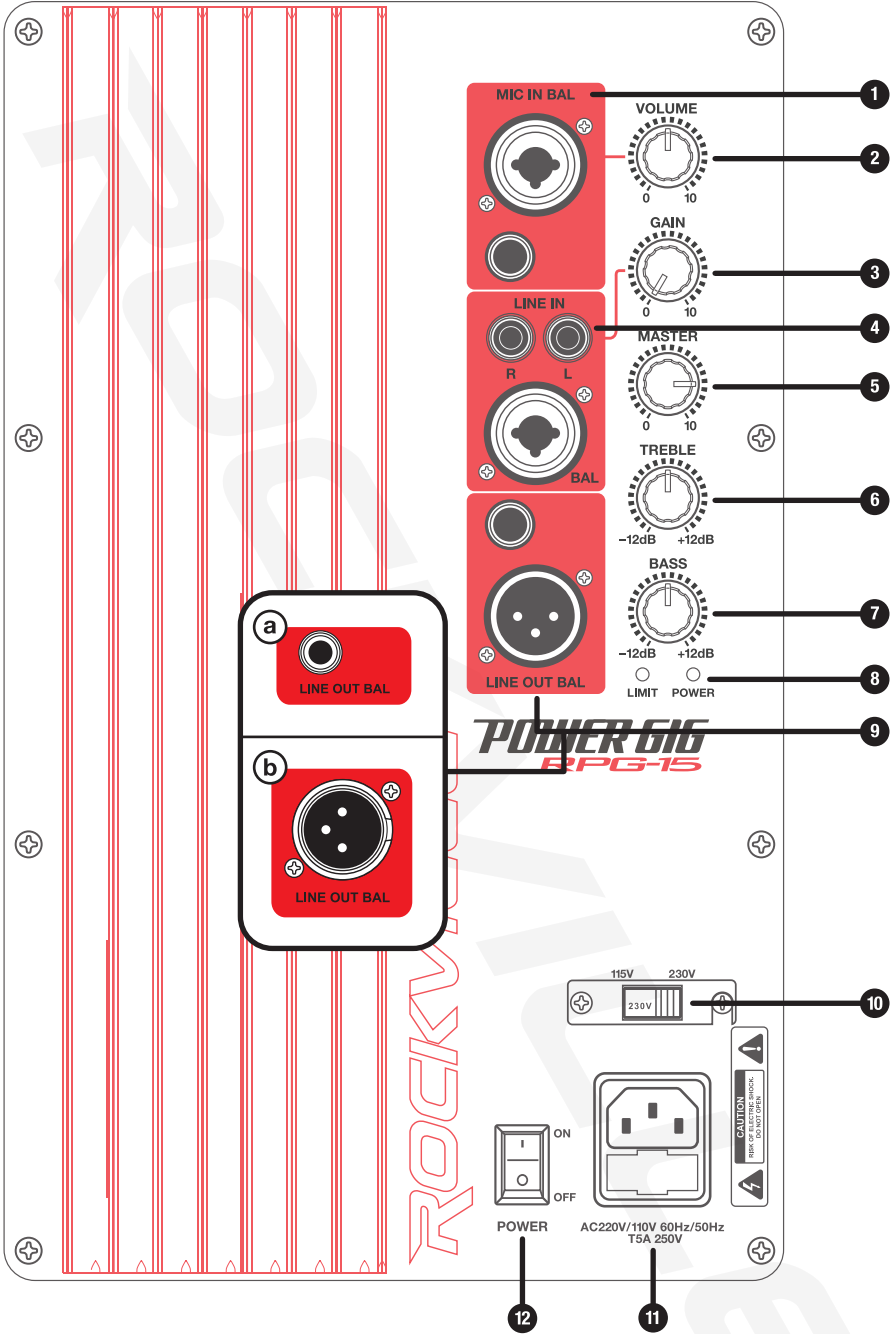

Features/Specifications

RPG8

- 100 Watt RMS/200 Watts Program Power/400 Watts Peak
- High power long-throw 8" woofer with 2" aluminum voice coil provides incredibly deep bass and acoustic power.
- Frequency Response: 50Hz – 20kHz
- Maximum SPL @1w/1m: 119dB peak/116dB continuous
- High-power 2-way pro sound reinforcement speaker system for live sound and playback applications
- Compact and light weight system delivers distortion free sound even at extreme SPL
- Linear Class AB amplifier technology: high power, transparent sonic performance
- Internal switch-mode power supply for low distortion audio with superior transient response
- Built-in bass and treble equalization processor for ultimate system control and speaker protection
- State-of-the-art 1" Japanese made pure titanium-diaphragm compression driver for crystal clear high-frequency reproduction
- Ultra-wide dispersion, 40° large-format horizontal wave guide horn molded directly into cabinet
- Ultra-low noise Mic input via XLR & ¼" TRS jacks with independent volume control
- Line RCA and XLR input with separate Gain adjustment
- Additional balanced line output via ¼" TRS jack for linking of additional speaker systems
- Versatile trapezoidal enclosure design allows different positioning
- Flyable (M8 Fly Points) and stand mounting with 35mm pole socket
- High-quality components and exceptionally rugged high impact ABS construction
- Power and clip limit LED indicators
- Front display power meter Blue LED
- 115/230 volt switchable power supply with external user-serviceable fusing (T3.15A 250V)
- Dimensions: 11.57" x 8.98" x 16.23"

RPG10

- 150 Watt RMS/300 Watts Program Power/600 Watts Peak
- High power long-throw 10" woofer with 2" aluminum voice coil provides incredibly deep bass and acoustic power.
- Frequency Response: 45Hz – 20kHz
- Maximum SPL @1w/1m: 122dB peak/119dB continuous
- High-power 2-way pro sound reinforcement speaker system for live sound and playback applications
- Compact and light weight system delivers distortion free sound even at extreme SPL
- Linear Class AB amplifier technology: high power, transparent sonic performance
- Internal switch-mode power supply for low distortion audio with superior transient response
- Built-in bass and treble equalization processor for ultimate system control and speaker protection
- State-of-the-art 1.34" Japanese made pure titanium-diaphragm compression driver for crystal clear high-frequency reproduction
- Ultra-wide dispersion, 40° large-format horizontal wave guide horn molded directly into cabinet

- Ultra-low noise Mic input via XLR & ¼" TRS jacks with independent volume control
- Line RCA and XLR input with separate Gain adjustment
- Additional balanced line output via XLR jack for linking of additional speaker systems
- Versatile trapezoidal enclosure design allows different positioning
- Flyable (M8 Fly Points) and stand mounting with 35mm pole socket
- Tilts on its side for use as a floor monitor with included brackets
- Ergonomically shaped handle for easy carrying and setup
- High-quality components and exceptionally rugged high impact ABS construction
- Power and clip limit LED indicators
- Front display power meter Blue LED
- 115/230 volt switchable power supply with external user-serviceable fusing (T2A 250V)
- Dimensions: 14.21" x 10.87" x 19.72"

RPG12

- 200 Watts RMS/400 Watts Program Power/800 Watts Peak
- High power long-throw 12" woofer with 2.5" aluminum voice coil provides incredibly deep bass and acoustic power.
- Frequency Response: 40Hz – 20kHz
- Maximum SPL @1w/1m: 125dB peak/122dB continuous
- High-power 2-way pro sound reinforcement speaker system for live sound and playback applications
- Compact and light weight system delivers distortion free sound even at extreme SPL
- Linear Class AB amplifier technology: high power, transparent sonic performance
- Internal switch-mode power supply for low distortion audio with superior transient response
- Built-in bass and treble equalization processor for ultimate system control and speaker protection
- State-of-the-art 1.34" Japanese made pure titanium-diaphragm compression driver for crystal clear high-frequency reproduction
- Ultra-wide dispersion, 40° large-format horizontal wave guide horn molded directly into cabinet
- Ultra-low noise Mic input via XLR & ¼" TRS jacks with independent volume control
- Line RCA and XLR input with separate Gain adjustment
- Additional balanced line output via XLR & ¼" TRS jack for linking of additional speaker systems
- Versatile trapezoidal enclosure design allows different positioning
- Flyable (M8 Fly Points) and stand mounting with 35mm pole socket
- Tilts on its side for use as a floor monitor with included brackets
- Ergonomically shaped handle for easy carrying and setup
- High-quality components and exceptionally rugged high impact ABS construction
- Power and clip limit LED indicators
- Front display power meter Blue LED
- 115/230 volt switchable power supply with external user-serviceable fusing (T5A 250V)
- Dimensions: 16.73" x 12.75" x 23.11"

Features/Specifications (continued)

RPG15

- 250 Watts RMS/500 Watts Program Power/ 1000 Watts Peak
- High power long-throw 15" woofer with 3" aluminum voice coil provides incredibly deep bass and acoustic power.
- Frequency Response: 35Hz – 20kHz
- Maximum SPL @1w/1m: 128dB peak/125dB continuous
- High-power 2-way pro sound reinforcement speaker system for live sound and playback applications
- Compact and light weight system delivers distortion free sound even at extreme SPL
- Linear Class AB amplifier technology: high power, transparent sonic performance
- Internal switch-mode power supply for low distortion audio with superior transient response
- Built-in bass and treble equalization processor for ultimate system control and speaker protection
- State-of-the-art 1.75" Japanese made pure titanium-diaphragm compression driver for crystal clear high-frequency reproduction
- Ultra-wide dispersion, 40° large-format horizontal wave guide horn molded directly into cabinet
- Ultra-low noise Mic input via XLR & ¼" TRS jacks with independent volume control
- Line RCA and XLR input with separate Gain adjustment
- Additional balanced line output via XLR & ¼" TRS jack for linking of additional speaker systems
- Versatile trapezoidal enclosure design allows different positioning
- Flyable (M8 Fly Points) and stand mounting with 35mm pole socket
- Tilts on its side for use as a floor monitor with included brackets
- Ergonomically shaped handle for easy carrying and setup
- High-quality components and exceptionally rugged high impact ABS construction
- Power and clip limit LED indicators
- Front display power meter Blue LED
- 115/230 volt switchable power supply with external user-serviceable fusing (T5A 250V)
- Dimensions: 15.67" x 15.57" x 26.93"

Replacing the Fuse

The RPG Series PA speakers feature an IEC power socket with a user-serviceable fuse compartment. Follow the steps below to replace a blown fuse. Make sure to replace the current fuse with one of the same value. Refer to pages 10 – 12 for each model's fuse rating.

1. Use a screwdriver to release the fuse holder.
2. Remove the fuse holder.
3. Remove the blown fuse (a). Extract the spare fuse (b). Replace the fuse (c).
4. Carefully re-insert the fuse holder. Ensure that it is properly seated.

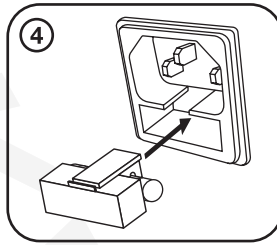
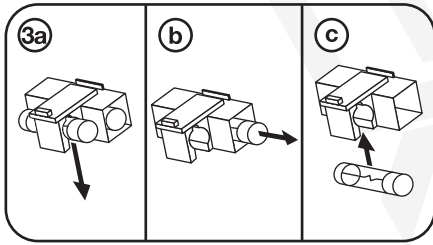
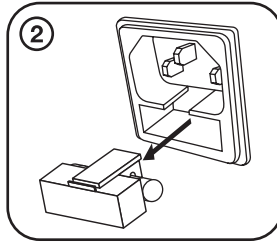
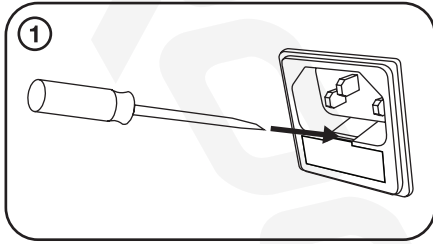

Troubleshooting

PROBLEM	SOLUTION
No power	<ol style="list-style-type: none"> 1. Make sure the unit is plugged in and the power switch is in the ON position. 2. Check that the power cable is plugged in tightly to the unit. 3. Check and replace the fuse if necessary. See fuse replacement diagram below. 4. If people or equipment tend to step and roll over or stretch your power cable it can get damaged. Always try a second cable to test for shorts in original cable. Dispose of original damaged power cables immediately.
No sound	<ol style="list-style-type: none"> 1. Check that all appropriate cables are plugged in correctly. 2. Check the Master Volume settings. 3. Be sure Volume and Gain of appropriate channels are set above 0 level and matched correctly. 4. Be sure your microphone is on. 5. If using a mixing console make sure fader and balance are set to center positions and levels are increased.
Buzzing sound	<p>Make sure you are using a proper cable. For ¼" cables, there are 3 types: instrument, TS (unbalanced), and TRS (balanced). Check the requirements of the connected gear and the input of the speaker and make sure you are using the appropriate cable.</p>

Troubleshooting (continued)

PROBLEM	SOLUTION
Mic feedback	Point the mics away from the speaker. Make sure the mics are in back of the speaker, not in front of it.
Poor Mic sound	1. Make sure you are using the Mic In port. 2. If using wireless mics connect them into the Line input of your mixer.
No SD or USB playback	1. Make sure you've selected the proper source. 2. Make sure that the audio files are in the specified format.

FEDERAL COMMUNICATIONS COMMISSION COMPLIANCE INFORMATION

Responsible party name: Rockville

Address: 600 Bayview Ave.
Entrance A
Inwood, NY 11096

Hereby declares that the product(s) RPG series pro audio speakers comply with FCC rules as mentioned in the following paragraph:

This device complies with Part 15 of the FCC rules. Operation is subject to the following two conditions: (1) this device may not cause harmful interference, and (2) this device must accept any interference received, including interference that may cause undesired operation.

Note: This equipment has been tested and found to comply with the limits for a Class B digital device, pursuant to Part 15 of the FCC rules. These limits are designed to provide reasonable protection against harmful interference in a residential installation. This equipment generates, uses and can radiate radio frequency energy and, if not installed and used in accordance with the instructions, may cause harmful interference to radio communications. However, there is no guarantee that interference will not occur in a particular installation. If this equipment does cause harmful interference to radio or television reception, which can be determined by turning the equipment off and on, the user is encouraged to try to correct the interference by one or more of the following measures:

- Reorient or relocate the receiving antenna.
- Increase the separation between the equipment and receiver.
- Connect the equipment into an outlet on a circuit different from that to which the receiver is connected.
- Consult the dealer or an experienced radio/TV technician for help.

Rockwell

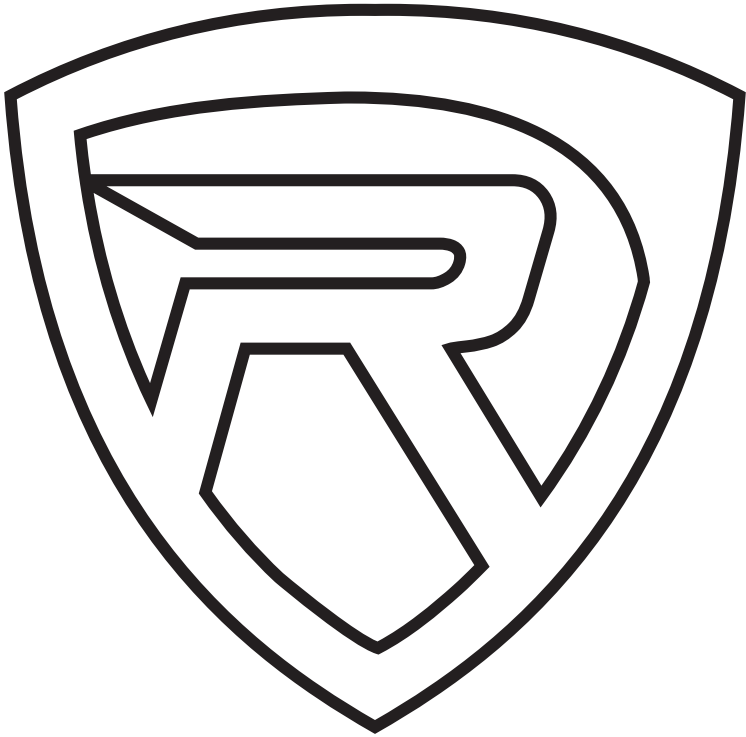

RockvilleAudio.com

© 2025 ROCKVILLE // Features and specifications are subject to change and/or improvement without notice.