

ROCKVILLE

RAMSYS Series

RAMSYS12/RAMSYS series

OWNER'S MANUAL

ATTENTION:
WATCH THIS VIDEO BEFORE FIRST USE!

Scan the **QR code** or visit the **URLs** for essential information, guides (video and/or written), and tips to make the most out of your purchase.

If you prefer written instructions, please read ahead!

With Rockville you get many options.



rockvillesupport.com/ramsys12

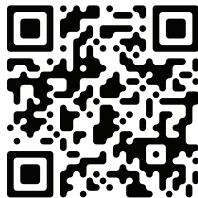

rockvillesupport.com/RAMSYS

Missing items? If you ordered a bundle that includes more than one product and you are missing part of your bundle then it just means your order shipped from two different warehouses. You will receive the remaining items very soon. If you have any concerns or inquiries, feel free to call our customer support center at 1-646-758-0144, 24 hours a day/7 days a week.

Thank you for purchasing this Rockville RAMSYS Series PA Speaker. Please read this installation guide carefully for proper use. Should you need assistance, please call our technical help line at 1-646-758-0144, 24 hours a day/7 days a week.

INCLUDES

RAMSYS12

- (2) 12" Rechargeable DJ/PA speakers (one active and one passive)
- (2) Rugged tripod speaker stands
- (2) Wireless microphones (battery included)
- ¼" Cable for active to passive speaker connection
- Power cable for active speaker
- Wireless remote control
- Owner's manual
- Video card

RAMSYS15

- (2) 15" Rechargeable DJ/PA speakers (one active and one passive)
- (2) Rugged tripod speaker stands
- (2) Wireless microphones (battery included)
- ¼" Cable for active to passive speaker connection
- Power cable for active speaker
- Wireless remote control
- Owner's manual
- Video card

IMPORTANT SAFETY INSTRUCTIONS



- To reduce risk of electric shock, never open the unit. There are no user serviceable parts, refer service to the Rockville service center.
- Do not expose this unit to any kind of moisture.
- Please ensure that the unit is situated in a properly ventilated area.
- Make sure the unit is placed on a level and stable surface.

Setting Up Your RAMSYS series Professional Sound System

Your RAMSYS series unit is set up to produce the full spectrum of sound from its woofer and tweeter horn combination. The lower frequencies seek out the floor of the room they are playing and travel along the floor and walls. The tweeter horn is more directional. Hence when setting up your system its more important to make sure that the tweeter horns are not blocked by any furniture and are located / aimed at ear level to the listening audience. Woofer aiming is not as critical as explained previously due to the nature of the woofer sounds able to travel through various paths even when blocked.

It is therefore recommended that when setting up your system you set up your speakers on the included speaker stands, so that the tweeter sounds will radiate above the listening crowd. This will guarantee optimum sound dispersion and achieve clear vocal sound reproduction.

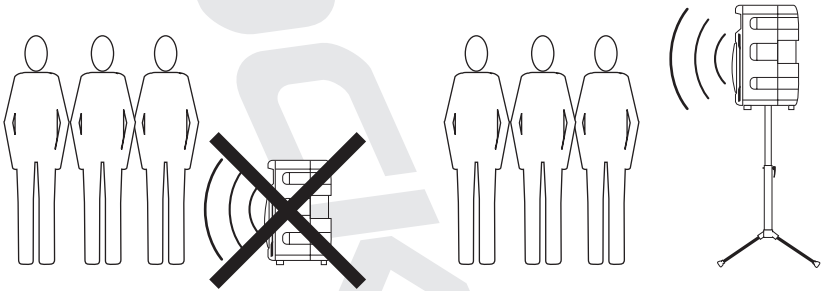

How To Avoid Irritating Feedback

The placement of your microphone is critical in avoiding feedback through your RAMSYS series speakers. Never set up your microphone in front of the speaker. Always set up your microphone behind the speaker. When approaching the speaker to make any adjustments, we recommend approaching the speaker from the rear and not walking directly towards the front of the speaker.

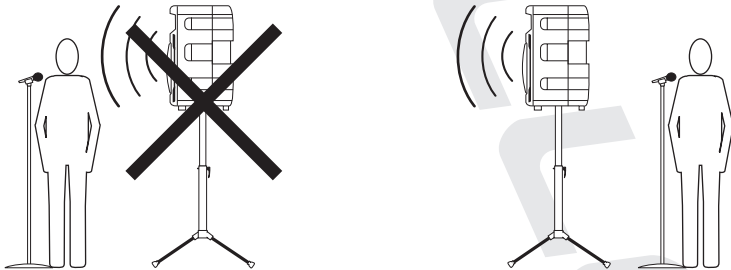

Setup Stands

1. Remove the stands from their packaging.
2. Loosen up the adjustment knob (fig. a) and spread the legs to the desired width (fig. b). We recommend spreading the legs to the point that the support bars are parallel with the floor. Retighten the leg adjustment knob so that the legs are securely positioned (fig. c). Do not overtighten.

fig. a



fig. b



fig. c



3. Loosen the stand extension by loosening the locking knob (fig. d). Lift the extension to the desired height (fig. e). Now insert the safety detent pin (fig. f). Make sure the pin goes all the way through the extension pole (fig. g). Retighten the locking knob, do not overtighten it.

fig. d



fig. e



fig. f



fig. g



Mounting the Speaker

1. Unpack the speakers loosen the locking knob located below the amp panel (refer to fig. i).
2. Carefully lift the speaker above the stand, lining up the extension pole with the mounting hole at the bottom of the speaker (fig. h). This step may require a second person for assistance.
3. Once the speaker is mounted on the stand, secure it by tightening the locking knob located behind the pole opening at the bottom the speaker (fig. i).

fig. h



fig. i



Connecting the Passive Speaker

To connect the passive speaker to the active unit, use the included $\frac{1}{4}$ " to $\frac{1}{4}$ " cable. Connect one end of the cable to the $\frac{1}{4}$ " port on the active unit marked Speaker Out (fig. j). Now connect the other end to the $\frac{1}{4}$ " port on the passive unit marked Speaker In (fig. k). Make sure that the power to the active unit is turned off before you connect the passive unit.

fig. j

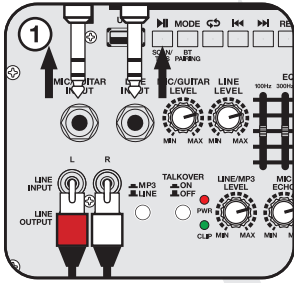

fig. k



Setting Level Controls

It is best practice to set your input level controls (gains) in this manner:



1. Unplug all inputs except for the one you wish to set the gain for. In this instance, the Line In RCA inputs. Set the MP3/Line level button to Line.

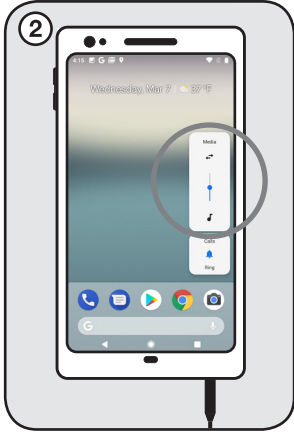

2. Set the line level input device volume (smart phone, tablet, MP3 player, etc.) to 60%.

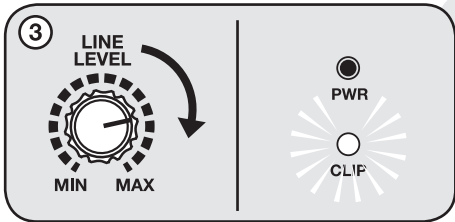

3. Slowly turn up the level on the selected input (in this case, the Line Level). As soon as the clip indicator LED goes on or you hear any distortion – turn it down one or two notches.

! PLEASE NOTE

Because mixers feature two volume controls (channel and master), when connecting one via the 1/4" line in port, the procedure is slightly different. The RAMSYS series Line Level should be set to 50%. Set the mixer master volume to 50% and make the adjustments in step 3 on the mixer channel level control. If after making these adjustments the signal still isn't strong enough, you can additionally boost the signal by turning up the Line Level control.

When adjusting the Mic Volume control, you must speak into the microphone and adjust the level control as needed. This is because adjustments to the mic input are a matter of mic volume in relation to the music volume and not necessarily a clipping issue.

Wireless Speaker Linking

The RAMSYS series features True Wireless Stereo (TWS) Bluetooth linking. This means you can purchase 2 RAMSYS series systems and link them together to play in stereo wirelessly.

1. Make sure both RAMSYS series active unit's power switches are in the ON position and that they are within 32 feet of each other. Set the MP3/Line level button to MP3.
2. Press the Mode button on both of the units to enter Bluetooth mode. The LCD screens should show that the speakers are not connected via Bluetooth or to another speaker.
3. Press the SCAN/TWS button on one of the units for 3 seconds (3a). If pairing is successful the unit's LCD screen will read "BLUETOOTH BT-A Connected" (3b). This is the primary and all functions will be controlled by this unit.
4. The secondary unit's LCD screen will read "BLUETOOTH BT-B Connected".
5. Once the speakers are connected, go to your phone's Bluetooth interface and select "RAMSYS12" or "RAMSYS15" from the list of devices. If connection is successful, you will hear the same audio from both unit's. You are now ready to enjoy true wireless stereo sound!

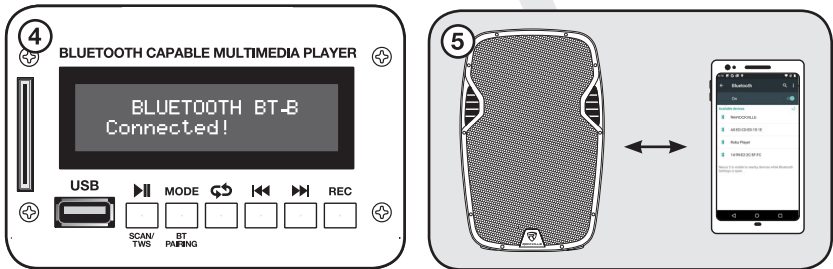
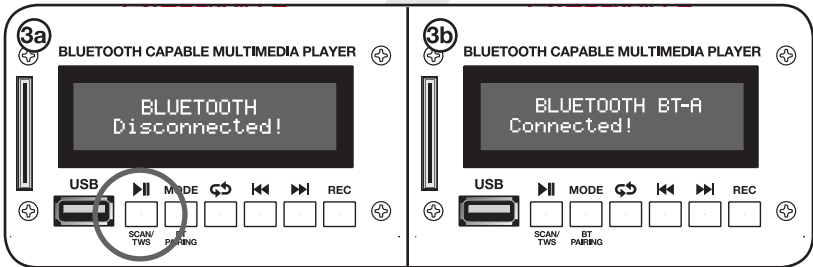
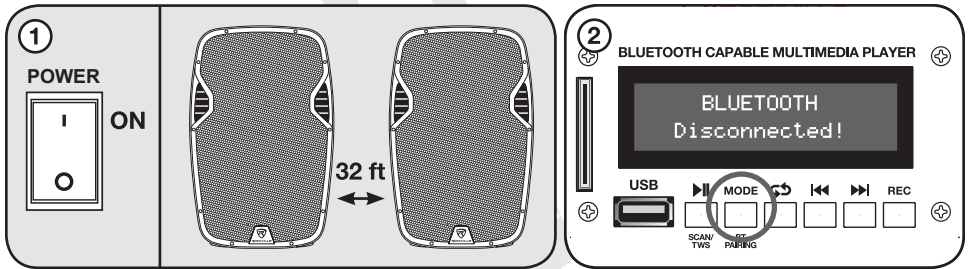

Wireless Speaker Linking (continued)

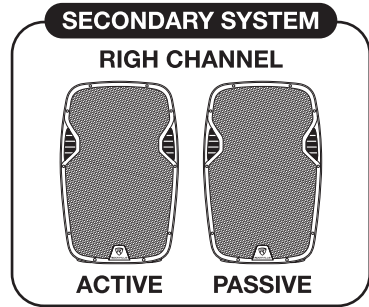
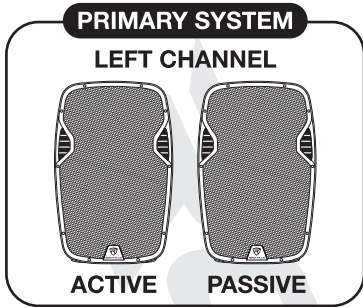

! PLEASE NOTE Once the systems are in TWS mode, the primary system becomes the left channel and the secondary system becomes the right channel. The active unit of the primary system will control all playback and volume functions.

APPLICATION USES

Microphone Presentations

Your RAMSYS series features ultra-low noise Mic input via a 1/4" TRS stereo jack.

1. Make sure the Power switch is in the OFF position.
2. Plug your microphone into the 1/4" jack labeled MIC/GUITAR INPUT.
3. Switch on the RAMSYS series unit.
4. Refer to the "Setting Level Controls" section of this manual for instructions on how to properly adjust the Mic Volume controls.

Always stand behind the Power Gig when making your microphone adjustments to avoid feedback distortion.

Talk over Feature

In the ON position the TALK OVER function gives the microphone priority over all other features so that the microphone's volume level will be higher. When the TALK OVER function is in the OFF position, the microphone can be used in conjunction with any other feature (Bluetooth, MP3, SD, etc.) at the same sound level.

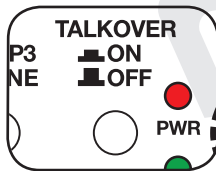

Line Input

You can use the Line In 1/4" input or the RCA inputs to connect a mixer or an additional stereo signal source such as a smart phone, tablet, MP3 player, CD player, etc.

1. Make sure the Power switch is in the OFF position.
2. Connect the mixer or line level signal source to the 1/4" jack input or the RCA inputs (**never use both at once**).
3. Switch on the RAMSYS series unit. Make sure the MP3/Line level button is set to Line.
4. Refer to the "Setting Level Controls" section of this manual for instructions on how to properly adjust the Line In level control (gains).

Wireless Microphone Set-Up

Your RAMSYS series unit comes with two wireless microphones. To connect the microphones to the unit follow these steps:

1. Make sure the RAMSYS units power switch is in ON position.
2. Keep the Master Volume at the Min position.
3. Keep both Mic A Volume and Mic B Volume at Min position.
4. Press the VHF power on button (red indicator LED should be on).
5. Switch on one microphone. It should automatically connect to the corresponding channel and the LED for that channel should light up.
6. To connect the second mic, simply switch it on.
7. Use the Mic A/Mic B volume controls to adjust each microphone's volume.
8. Adjust the master volume as necessary.

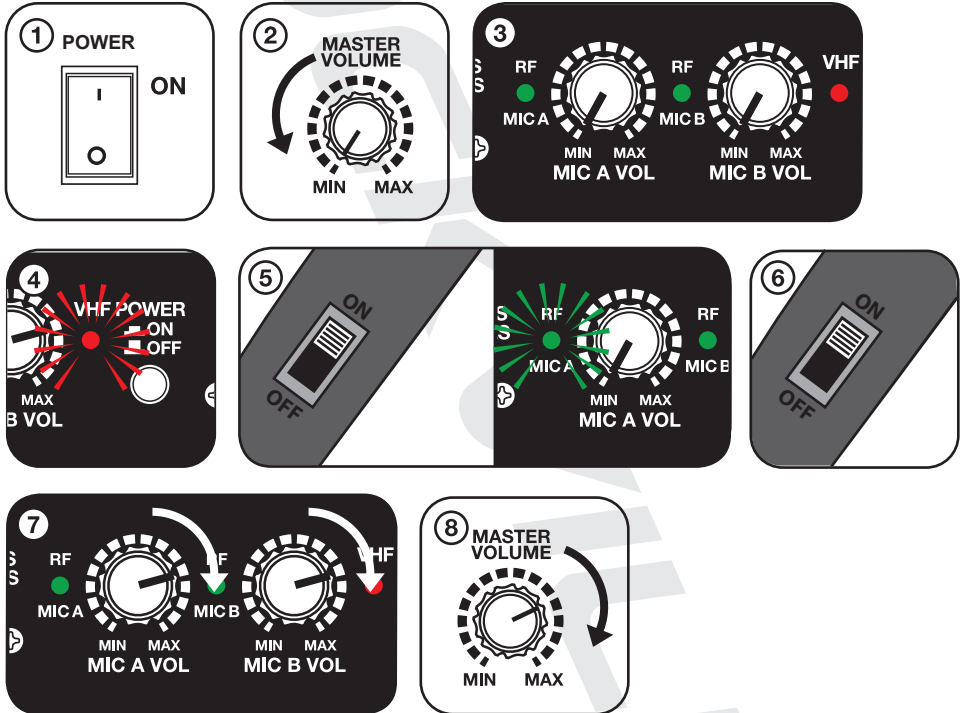

Record Function (continued)

You can record the input from any mic or line input source to a USB or SD card.

1. Make sure there is a USB or SD card inserted and that your input source is ready.
2. Press the red record button to begin recording. The LCD display will read INITIAL. Press the red record button to stop recording and save the audio files.
3. Saved files will be named REC0001.MP3, REC0002.MP3, REC0003.MP3, etc. Use the Previous/Next buttons to find the files on the USB disc or SD card.

Record Function (continued)

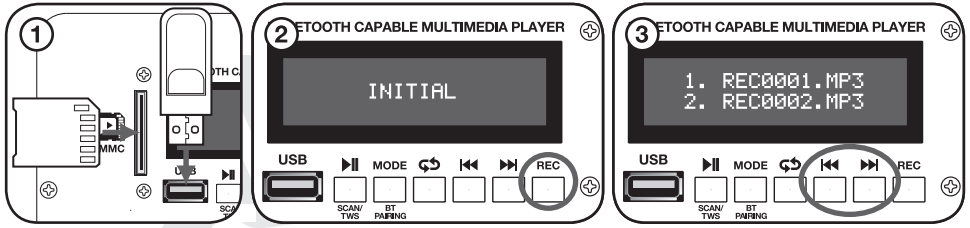

Line Out Balanced Connection.

The RCA Line Out allows you to send the amplifier signal to another amplifier to power passive speakers, to a powered speaker, or to a powered subwoofer. Use a dual RCA to dual RCA, RCA to XLR, or RCA to 1/4" TRS cable to share the signal. We recommend using high quality cables such as Rockville's RCDR series dual RCA to dual RCA cables, RXLRDRCA series XLR to dual RCA cables, or the RNRTR series 1/4" TRS to dual RCA cables.

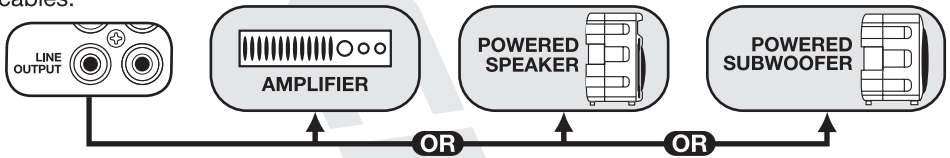

Bluetooth Pairing

To connect your iPod, iPhone, MP3 player, Android phone or any other Bluetooth capable device follow the steps listed below.

1. Make sure the RAMSYS series unit's power switch is in the ON position and the MP3/ Line button is set to MP3.
2. Turn on the Bluetooth feature on your device.
3. Push the Mode/BT Pairing button on your RAMSYS series unit until you are in Bluetooth mode. The LCD screen will read "BLUETOOTH Disconnected"
4. Once in Bluetooth mode, the unit should show up on your device as "RAMSYS12" or "RAMSYS15". Select it from your list of available devices.
5. If pairing is successful, the LCD screen will read "BLUETOOTH Connected". You can now begin to stream music.
6. Playback functions can be controlled via your device or the RAMSYS unit.



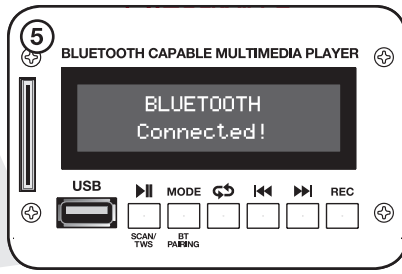
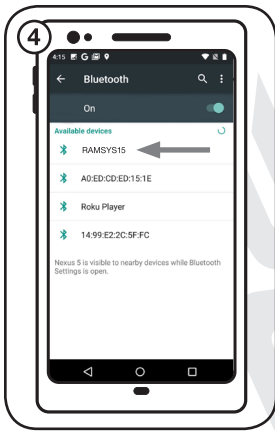

USB/SD

The built-in USB and SD inputs allow you to play digital music files from a thumb drive or an SD card.

1. Make sure the RAMSYS series unit's power switch is in the ON position and the MP3/Line button is set to MP3.

2. Connect a thumb drive or SD card to the unit. Music should begin playing automatically.

Please note: USB/SD input will override BT input. Accepts SD cards and USB drives of up to 32GB max and these file formats - MP3, WAV, WMA.

Built-in Battery

These units include a built-in 12 volt, 9 amp battery. This convenient features allows you to use your RAMSYS series for up to 10 hours* on a full charge in any situation where outlets are not readily available. A battery status LED indicator lets you know the status of the battery and when to charge it. To charge the battery simply plug it to an outlet. It will take approximately 6 hours to charge. While charging, the LED will be red (fig. a). It is fully charged when the LED is blue (fig. b). When the battery is drained it is important that you immediately turn off your unit to prevent damage to the battery.

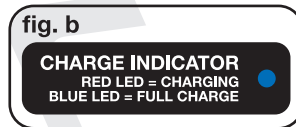
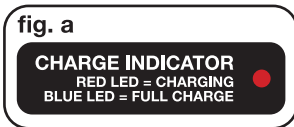

*Playback time is based on volume levels.

Functions

Remote Control

1. MODE: select input mode -- Bluetooth, SD, USB, RADIO.

2. FOLDER -/FOLDER+: Navigate through file folders while in SD or USB mode.

3. PREVIOUS TRACK/NEXT TRACK: While in SD, USB, and Bluetooth mode press to move forward or back through tracks. While in RADIO mode press to navigate through programmed stations.

4. PLAY/PAUSE: While in SD, USB, and Bluetooth mode press once to play track, press again to pause. While in RADIO mode, press and hold for 3 seconds to enable automatic station programming.

Functions (continued)

5. VOL-/VOL+: Raise or lower master volume.
6. EQ: Press to cycle through preset EQs while in USB and SD modes. Normal, Rock, Pop, Jazz, Country.
8. MULTI-DIGIT BUTTONS: These buttons correspond to the keypad. They allow you to select multi-digit track numbers. Simply press the appropriate multi-digit button (double dash to enter 2 digits, triple dash to enter 3 digits), then enter the numbers on the keypad.
7. KEYPAD: Direct select tracks while in SD and USB mode. While in RADIO mode, use to direct select programmed stations. It will not allow you to select individual stations.

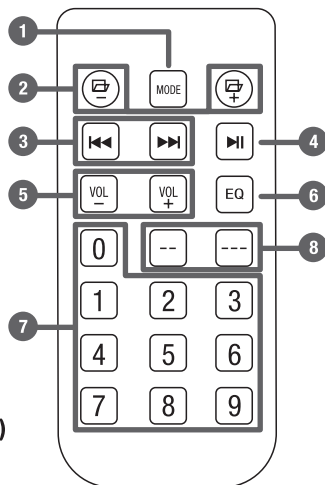

Active Unit (RAMSYS15 shown for display purposes)

1. LCD display
2. USB and SD/MMC Card inputs: Accepted file formats are MP3, WAV, WMA
3. MP3 Player controls:
 - Play/Pause, Scan, TWS - Press this button once to start music playback; press again to pause. In FM radio mode press and hold for 5 seconds to automatically scan and save all available stations. See page 7 for TWS pairing procedure.
 - Mode - Switches between input modes: Bluetooth, USB, SD / MMC, and FM Radio.
 - Repeat - Press once to repeat current track, press again to repeat all tracks. Press a third time to exit repeat mode.
 - Previous/Next track buttons also serve as volume controls. For track control quickly press button. For volume control press and hold button.
 - Rec: Press to record Mic and Line input to a USB or SD card (see page 9)
4. Mic/Guitar level input volume control
5. Line level input volume control
6. ¼" Line level input
7. ¼" TRS Mic/Guitar input
8. 5 band equalization control panel
9. L/R RCA line inputs
10. L/R RCA line outputs
11. MP3/Line Input selector switch
12. Talk over On/Off selector switch: gives priority to mic input
13. Master volume
14. Mic echo effect control
15. Line/MP3 volume control (RCA, USB, SD, and Bluetooth input)
16. Power and clip LED indicators
17. Wireless Microphone VHF transmitter power control
18. Mic A and B connection indicator LEDs and Volume controls
19. Mic A antenna
20. Mic B antenna
21. Internal battery status indicators (see page 11)

22. IEC AC power socket w/user serviceable fuse (see page 16 for fuse replacement)

23. Power switch

24. 1/4" Speaker output: used to send the signal to the passive speaker.

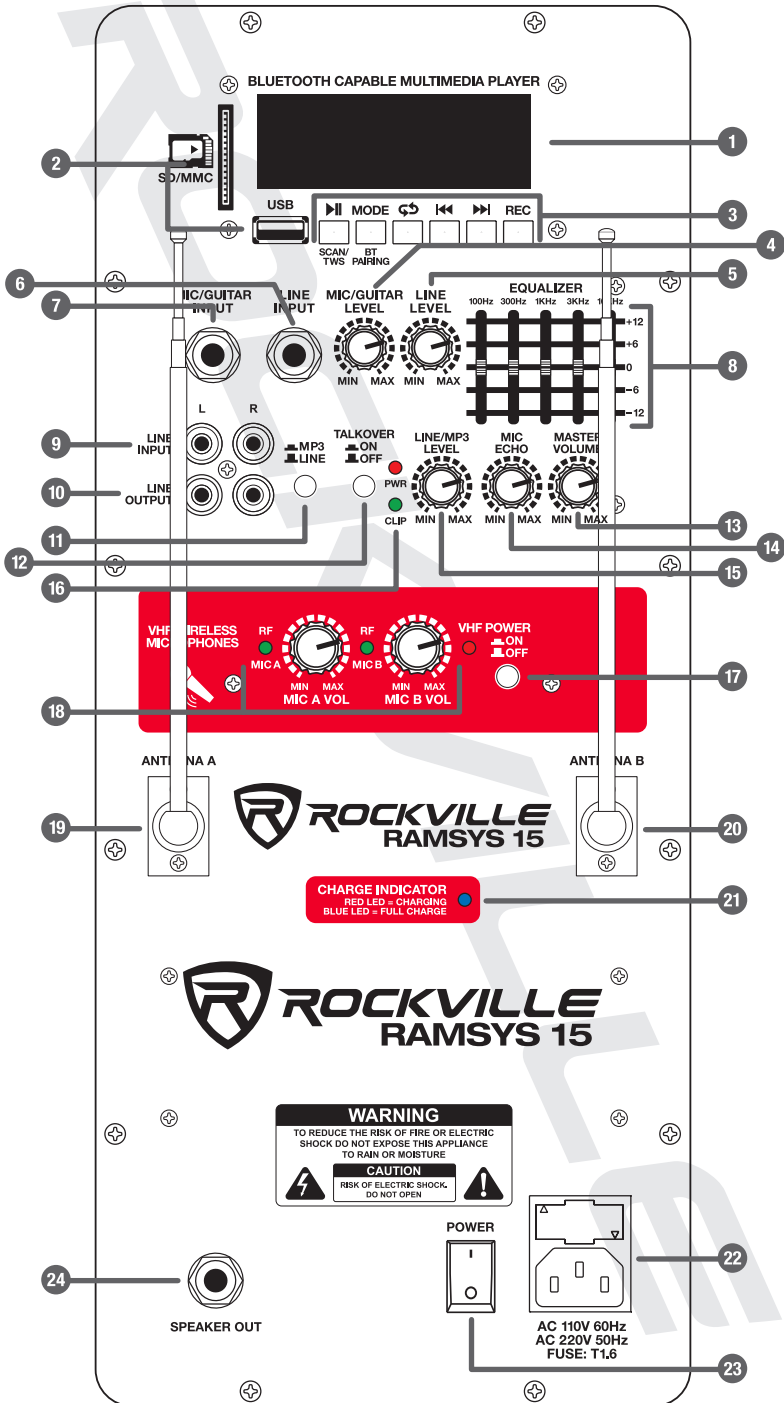

Features

- Main speaker has a rechargeable battery and connects with the included cable to the passive speaker giving you a complete speaker system that can be used outdoors with no outlet!
- Includes two high quality wireless microphones
- Bluetooth connectivity
- Power Ratings
 - RAMSYS15: 1000 watts peak/250 watts RMS
 - RAMSYS12: 800 watts peak/200 watts RMS
- Built-in USB playback (32GB max)
- Built-in FM radio tuner
- High-power class A/B amplifier built into the active speaker
- TWS - True Wireless Stereo allows you to link 2 RAMSYS systems together wirelessly allowing you to use 4 speakers without needing to plug them into an outlet!
- 5 Band Equalizer
- AUX RCA line in
- RCA line out to connect a powered subwoofer, amplifier, or additional powered speakers
- (1) ¼" Mic/guitar input
- (1) ¼" Line input
- Microphone range: 114 feet
- Built-in 12V-9Ah battery
- Speaker can play for 4 – 10 hours per charge*
- AC Power input with built-in battery charger
- Built-in wheels and carry handles for easy transport
- 40oz Woofer magnet (both models)
- 4-ohm 2" KSV voice coils (both models)
- 25mm, 8-ohm titanium diaphragm tweeter (both models)
- Total unit weight (includes two speakers and two stands)
 - RAMSYS15: 77Lb
 - RAMSYS12: 60.1Lb
- Overcharge battery protection

*Playback time is based on volume levels.

Troubleshooting

PROBLEM	SOLUTION
No power	<ol style="list-style-type: none"> 1. Make sure the unit is plugged in and the power switch is in the ON position. 2. Check that the power cable is plugged in tightly to the unit. 3. Check and replace the fuse if necessary. See fuse replacement diagram on page 16. 4. Make sure the battery is fully charged. See charging procedure on page 11.
No sound/ distorted sound	<ol style="list-style-type: none"> 1. Check that all appropriate cables are plugged in correctly. 2. Check the gains, master volume settings, source device settings, etc.. 3. Be sure your microphone is on. 4. If using a mixing console, make sure fader and balance are set to center positions and levels are increased.
Buzzing sound	<p>Make sure you are using a proper cable. For ¼" cables, there are 2 types: TS (unbalanced), and TRS (balanced). Check the requirements of the connected gear and the input of the speaker and make sure you are using the appropriate cable.</p>
Mic feedback	<p>Point the mics away from the speaker. Make sure the mics are behind the speaker, not in front of it (see page 3). Lower the gain.</p>
Poor Mic sound	<ol style="list-style-type: none"> 1. Make sure you are using the Mic In port. 2. If using wireless mics, check the batteries, the volume settings, and make sure the antennas are fully extended.
Not enough bass	<p>Add a subwoofer to your setup – PA speakers do not play deep frequencies as well as a subwoofer. Regardless of brand or model, if you want deep thumping bass you must add a subwoofer.</p>
Bluetooth pairing fails	<ol style="list-style-type: none"> 1. Check to see that both devices are turned on and that your Bluetooth device is discoverable. 2. Turn both devices off and then on again. 3. Make sure you've selected the proper source. 4. Make sure that the Bluetooth device is within 5 feet of the unit. 5. Move both devices away from other Bluetooth devices, microwaves, wireless routers, and other electronics. 6. Make sure that the unit is not paired to a previously paired device.
TWS pairing fails	<ol style="list-style-type: none"> 1. Check to see that both devices are turned on. 2. Make sure both devices are in Bluetooth mode. 3. Make sure both RAMSYS systems are near each other. 4. Make sure that the unit is not paired to a previously paired device. 5. If TWS pairing is successful, but Bluetooth pairing to the main unit fails, please look at the "Bluetooth pairing fails" section above.
No SD or USB playback	<ol style="list-style-type: none"> 1. Make sure you are in USB/SD mode. 2. Make sure the SD card or USB drive is properly connected. 3. Make sure that the audio files are in the specified format (see page 12). 4. Make sure the SD card/USB drive is not damaged.

Replacing the Fuse

① Use a screwdriver to release the fuse holder.

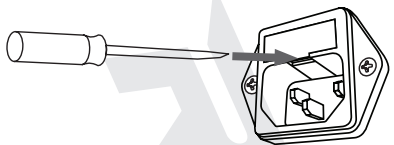

② Remove the fuse holder.

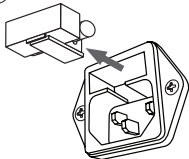

③ Remove the fuse.

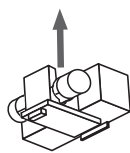

④ Replace the fuse.

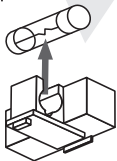

⑤ Re-insert the fuse holder.

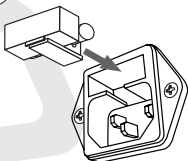

FEDERAL COMMUNICATIONS COMMISSION COMPLIANCE INFORMATION

Responsible party name: Rockville

Address: 600 Bayview Ave.
Entrance A
Inwood, NY 11096

Hereby declares that the product(s) RAMSYS15 AND RAMSYS12 comply with FCC rules as mentioned in the following paragraph:

This device complies with Part 15 of the FCC rules. Operation is subject to the following two conditions: (1) this device may not cause harmful interference, and (2) this device must accept any interference received, including interference that may cause undesired operation.

Note: This equipment has been tested and found to comply with the limits for a Class B digital device, pursuant to Part 15 of the FCC rules. These limits are designed to provide reasonable protection against harmful interference in a residential installation. This equipment generates, uses and can radiate radio frequency energy and, if not installed and used in accordance with the instructions, may cause harmful interference to radio communications. However, there is no guarantee that interference will not occur in a particular installation. If this equipment does cause harmful interference to radio or television reception, which can be determined by turning the equipment off and on, the user is encouraged to try to correct the interference by one or more of the following measures:

- Reorient or relocate the receiving antenna.
- Increase the separation between the equipment and receiver.
- Connect the equipment to an outlet on a circuit different from that to which the receiver is connected.
- Consult the dealer or an experienced radio/TV technician for help.

ROCKWELL

ROCKWELL

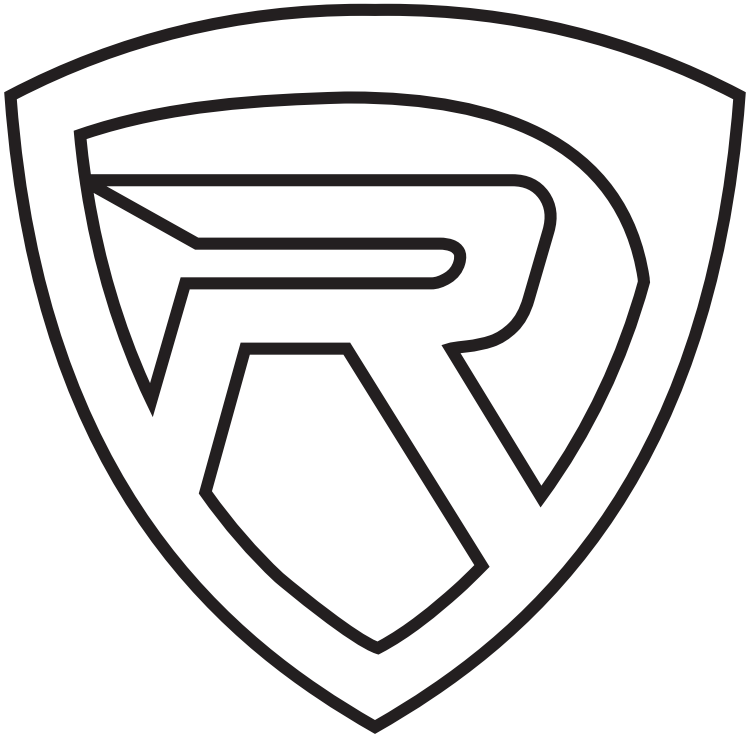

ROCKVILLE

RockvilleAudio.com

© 2025 ROCKVILLE // Features and specifications are subject to change and/or improvement without notice.