

# FLIP PAR Operating Instructions

Thank you for purchasing this Rockville FLIP PAR. Please read these operating instructions carefully. Should you need assistance, please call our technical help line at 1-646-758-0144, 24 hours a day/7 days a week. For how-to videos, this DMX guide, download links to the Par-Control app for Android and iOS (found on the support site, under the DOWNLOADS tab), and other helpful information, visit the URLs or scan the QR codes. The phone apps can also be download from the Google Play store and the Apple app store respectively.



[rockvillesupport.com/flip-par-black](http://rockvillesupport.com/flip-par-black)



[rockvillesupport.com/flip-par-white](http://rockvillesupport.com/flip-par-white)

## Functions

1. IR receiver
2. Lenses
3. Flip light enclosure
4. LED screen
5. MENU: Press to switch between modes  
UP: Scroll up through values for selected mode  
DOWN: Scroll down through values for selected mode  
ENTER: Press to access available submenus for the selected mode.
6. Mounting bracket attachment point
7. Wireless 2.4Ghz (DMX/Slave) antenna
8. Power button
9. IEC power socket w/user serviceable fuse
10. DMX in port and DMX out port
11. Charging status LED indicator: Red when charging, off when fully charged.

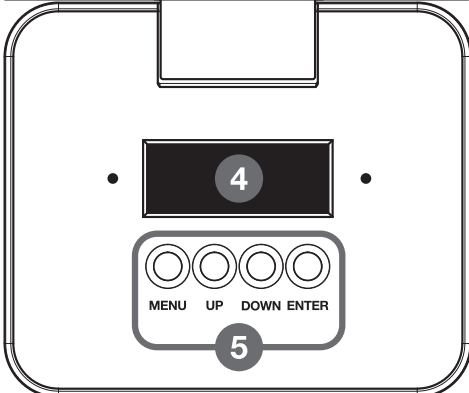
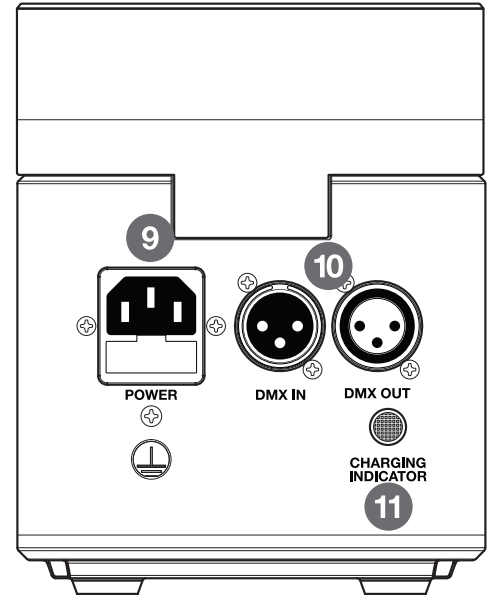
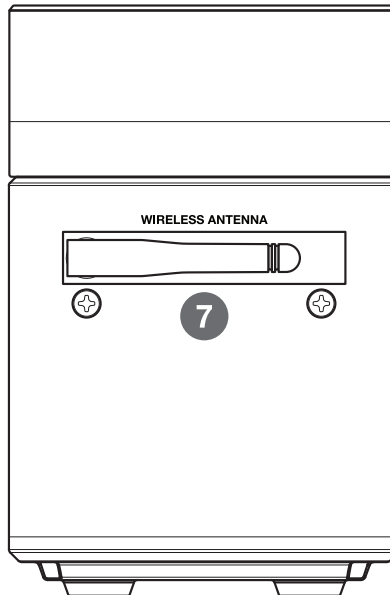
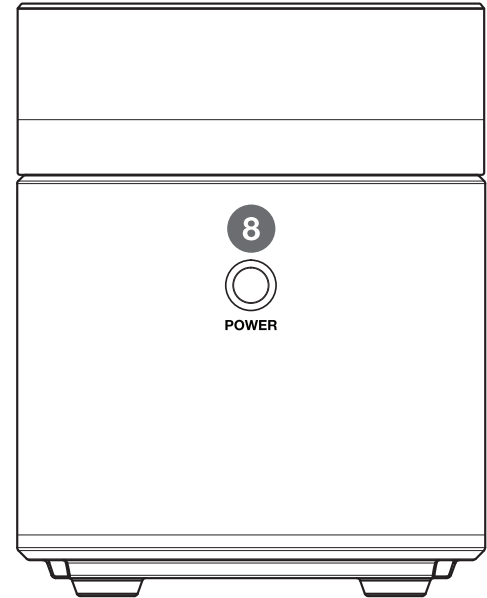
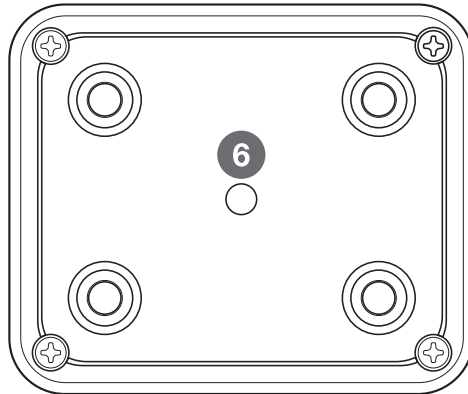
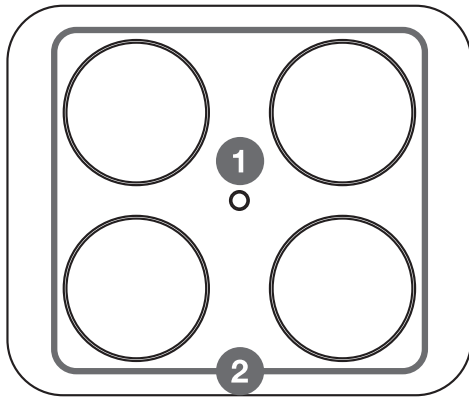

## Remote Control Functions

1. ☀️/🌑 (BRIGHTNESS): Adjust overall brightness in any mode. **If your light seems dim even after setting the light to the highest brightness level, navigate to the bR menu (page 4) and set it to br4 for maximum brightness.**

2. BLACK OUT: Turns the LEDs on/off. The LCD screen will display the word “oFF.” Please note, this button is strictly for the LEDs. The unit will remain on and continue to use battery power. To turn it off, use the POWER button on the unit (no. 6 on the functions diagram above). Press any button and the unit will return to normal operation.

3. ON: When the unit is in BLACK OUT mode, pressing this button will bring it out of BLACK OUT mode. It will be on the same setting as it was before.

4. WIRELESS GROUP ID UP/DOWN: Use the these buttons to cycle up or down through the 8 available options which are oFF (disables wireless grouping) and wireless groups 1 – 7.

5. APP GROUP UP/DOWN: Press these buttons to cycle through and assign your light to any one of the four app groups (AP1 – AP4). Once the light is assigned to a group, all lights within that group can be controlled via the Rockville DJ Link (Android) and Par-Control (iOS) phone apps. It is available for download from the Google Play store, the Apple app store or scan the QR code(s) above and click on the DOWNLOADS tab.

6. 🎵 (SOUND MODES)

- Press these buttons to select the desired sound mode. 1: color cycle sound mode, 2: color pulse sound mode, 3: color strobe sound mode, and 4: color cycle + pulse + strobe sound modes.
- Use the SENS UP/DOWN buttons to adjust the selected sound mode’s sensitivity.

7. SLAVE/DMX

- Press the SLAVE/DMX button to access the DMX menu. Press it repeatedly to switch between the DMX address screen and DMX channel setting screen. This button is also used in conjunction when setting lights in master/slave and phone app.
- Use the SLAVE/DMX UP/DOWN buttons to make changes.

8. AUTO MODES

- Press the AUTO MODES button to switch between color cycle change (JUMP on screen) mode, color fade change (FADE 01 on screen), and color pulse change (FADE 02 on screen).
- Use the MODE SPEED UP/DOWN buttons to set selected mode’s speed.

9. STROBE

- While in COLOR mode, use the color wheels to select the desired color, then press the STROBE button to set the unit to strobe mode.
- Use the STROBE SPEED buttons to set the strobe speed. Use the brightness buttons (1) to adjust the brightness.

10. COLOR BANK

- Press the COLOR BANK button to access the 48 available preset colors.
- Use the COLOR ADJUST UP/DOWN buttons to cycle through the colors and select the desired one.

11. COLOR WHEELS: There are six color wheels, each with eight color options. Press any one of the six buttons to select your color, then use the COLOR ADJUST UP/DOWN buttons (10b) to cycle through the options for that color. Press the brightness buttons (1) to adjust the brightness.



## Modes

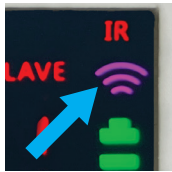

### DMX/SLAVE

If not already on the DMX screen, press the MENU button until you see DMX on the top left side of the LED screen. Here you can set the DMX address and channel mode. This will allow the light to communicate wirelessly with other lights. When the slave lights connect to the master the wireless group ID icon will flash (refer to the image on the left, also see Wireless Group ID Settings section) indicating that they are synced.



### Address

The ADD (address) submenu appears first. Use the UP/DOWN buttons to set the DMX address (001 – 512). Press the ENTER or MENU buttons to proceed to the next submenu, CH.



### Channel

In the CH. (channel) submenu press the UP/DOWN buttons to switch between 6 or 10 channel modes. Press the MENU button to proceed to the next mode, COLOR.



## DMX Controller Functions

When using a DMX controller, use the charts below to reference each channel's function.

### 6-Channel Mode

Channel	Function	Value	Description
1	Red	0 – 255	Adjust individual color brightness
2	Green	0 – 255	
3	Blue	0 – 255	
4	White	0 – 255	
5	Amber	0 – 255	
6	UV	0 – 255	

### 10-Channel Mode

Channel	Function	Value	Description
1	Master dimmer	0 – 255	Adjust overall brightness
2	Red	0 – 255	Adjust individual color brightness
3	Green	0 – 255	
4	Blue	0 – 255	
5	White	0 – 255	
6	Amber	0 – 255	
7	UV	0 – 255	
8	Strobe	0 – 9	Strobe off
		10 – 255	Set strobe speed, slow to fast
9	Manual dimming (CH1 – CH8 valid)	0 – 39	Set functions
	Color cycle change	40 – 79	
	Color fade change	80 – 119	
	Color pulse change	120 – 159	
	Color cycle sound mode	160 – 189	Set specific sound mode.
	Color pulse sound mode	190 – 219	
	Color strobe sound mode	220 – 249	
	Color cycle + pulse + strobe sound mode	250 – 255	Cycles through the three sound modes.
10	CH9 Speed	0 – 255	CH 9 function speeds, slow to fast

### COLOR (Solid Static Color)

From the DMX menu, press the MENU button (twice if the unit is in the ADD submenu) to enter the COLOR menu. Press the ENTER button to switch between the two submenus, SUB and SPEED.

#### Sub

The SUB submenu appears first. Use the UP/DOWN buttons to select one of the 48 preset colors (01 – 48). Press the ENTER or MENU buttons to proceed to the next submenu.

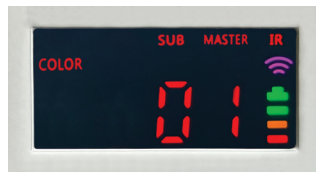

#### Speed

In the SPEED submenu press the UP/DOWN buttons to set the strobe speed, 00 (off) – 09 (fast). Press the MENU button to proceed to the next mode, JUMP.



### JUMP (Color Cycle Change)

From the COLOR menu, press the MENU button (twice if the unit is in the SUB submenu) to enter the JUMP menu. In this mode the unit cycles through all colors. Press the UP/DOWN buttons to set the speed, 01 (slow) – 09 (fast). Press the MENU button to proceed to the next mode, FADE.



### FADE (Color Fade Change and Color Pulse Change)

From the JUMP menu, press the MENU button to enter the FADE menu. Press the ENTER button to switch between the two submenus, SUB and SPEED.

#### Sub

The SUB submenu appears first. Use the UP/DOWN buttons to select one of the two settings. SUB 01 will continuously fade from one color to another (color fade). SUB 02 also fades through colors, but fully fades before moving to the next color (color pulse).



#### Speed

In the SPEED submenu press the UP/DOWN buttons to set the speed, 01 (slow) – 09 (fast). Press the MENU button to proceed to the next mode, 🎵 (sound).



## 🎵 (SOUND)

From the FADE menu, press the MENU button (twice if the unit is in the SUB submenu) to enter the 🎵 (sound) menu. Press the ENTER button to switch between the two submenus, SUB and SPEED. There are four sound modes: **1 Color Cycle sound mode:** cycles to a different solid color whenever sound is sensed, **2 Color Pulse sound mode:** pulses to a different color when sound is sensed and if there is no sound or a lull in the sound, the light will fade, **3 Color Strobe sound mode:** strobes a different color when ever sound is sensed, and **4 Color cycle + pulse + strobe sound mode:** cycles through the three sound modes.

### Sub

The SUB submenu appears first. Use the UP/DOWN buttons to select one of the 4 sound modes. (see above). Press the ENTER to proceed to the next submenu.

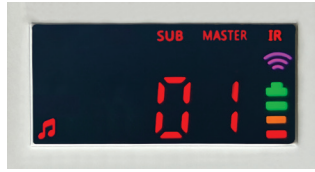

### Speed

In the SPEED submenu press the UP/DOWN buttons to set the sensitivity, 01 (least sensitive) – 09 (most sensitive). Press the MENU button to proceed to the next mode, AP



## AP (Phone App)

From the 🎵 (sound) menu, press the MENU button (twice if the unit is in the SUB submenu) to enter the AP (phone app group) menu. Use the UP/DOWN buttons to select one of the 4 app groups. (AP1 – AP4).



### UID

While in AP mode, press the ENTER button to see the unit's Unique Identification Number (UID). This is the unit's unique wifi tag and is used for when synching a light as a master to the app. Each and every unit will have one.



## CoL (Custom Color Mixing)

From the AP menu, press the MENU button to enter the CoL (custom color mixing) menu. Press the ENTER button to switch between colors: r (red), G (green), b (blue), u (white), Y (amber), and P (UV), in that order. Use the UP/DOWN buttons to adjust each individual color's brightness, 00 (off, image 1) to 99 (brightest setting, image 2). **MINI IR4 shown for reference.**



You can adjust an individual color's brightness (image 3) or multiple colors at once. Please note that if you have more than one color "on", it will affect the final color output. For example, if you have red and white on together, the color you see will be a mixture of white and red (image 4). As you add or subtract colors, or adjust the colors' brightness, the hue of the light output will change. Image 4 shows the color output when UV is added to the red and white mix. **MINI IR4 shown for reference.**



## br

From the CoL menu, press the MENU button to enter the br (master dimmer) menu. This mode allows you to set the brightness of the light directly from the unit MENU without having to use brightness adjustment buttons on the remote. Press the UP/DOWN buttons to select one of the 4 brightness levels: br1, br2, br3, and br4; 1 being the dimmest and 4 the brightest. **MINI IR4 shown for reference. PLEASE NOTE: If your light seems dim, access this menu and set it to br4 for maximum brightness.**





### dSP (LCD Screen Time Out Setting)

From the br menu, press the MENU button to enter the dSP (LCD screen time out setting) menu. This will determine how long the LCD menu screen will remain on after after no input from the remote or pressing any of the four panel buttons. This feature is especially useful when truss mounting the units. To activate, press ENTER, then use the UP/DOWN buttons to cycle through and select one of the time settings (on: always on, 10: screen remains on for 10 secs, 20: screen remains on for 20 secs, 30: screen remains on for 30 secs.)

### WIRELESS GROUP ID SETTINGS

From the dSP menu, press the MENU button to enter the wireless group ID settings menu. This feature is used for wireless DMX consoles, master slave of units, and phone app function. To sync with a DMX controller or master light, the slave light(s) need to be in the same color grouping. Multiple different groups can run at once. Use the UP/DOWN buttons to cycle through the wireless frequency settings (off: wireless option is off, 1: red wireless frequency group, 2: green wireless frequency group, 3: yellow wireless frequency group, 4: blue wireless frequency group, 5: purple wireless frequency group, 6: cyan wireless frequency group, 7: white wireless frequency group).

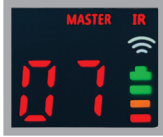

### IR (Remote Control Settings)

From the wireless frequency settings menu, press the MENU button to enter the IR (Infra Red) menu. Press the UP/DOWN buttons to turn this function on or off. To use the remote select “on” (1) or select “oFF” to disable the remote control function (2). Please note, when the remote control function is off, you will no longer see the letters “IR” at the top right corner of the display screen when going to other menus.



### MASTER/SLAVE

From the IR menu, press the MENU button to enter the MASTER (Master/Slave) menu. Press the UP/DOWN buttons to turn this function on or off. When set to off, the unit will not send a signal and the word “MASTER” will not be visible on the screen once you leave the Master/Slave mode menu.



**Master Mode:** When Master mode is turned on, the particular unit will control any units that are within the same wireless group ID. This means that all slave units will respond to any commands sent from the master unit.

**Slave Mode:** When Master mode is turned off, the unit will not send a signal. When placed in a wireless group ID, the slave unit (or units) will respond to any commands received by the master unit (see Master Mode above). Please note, the slave unit must be in the same wireless group ID as the master unit. Refer to the Wireless Group ID Settings section on the previous page.